

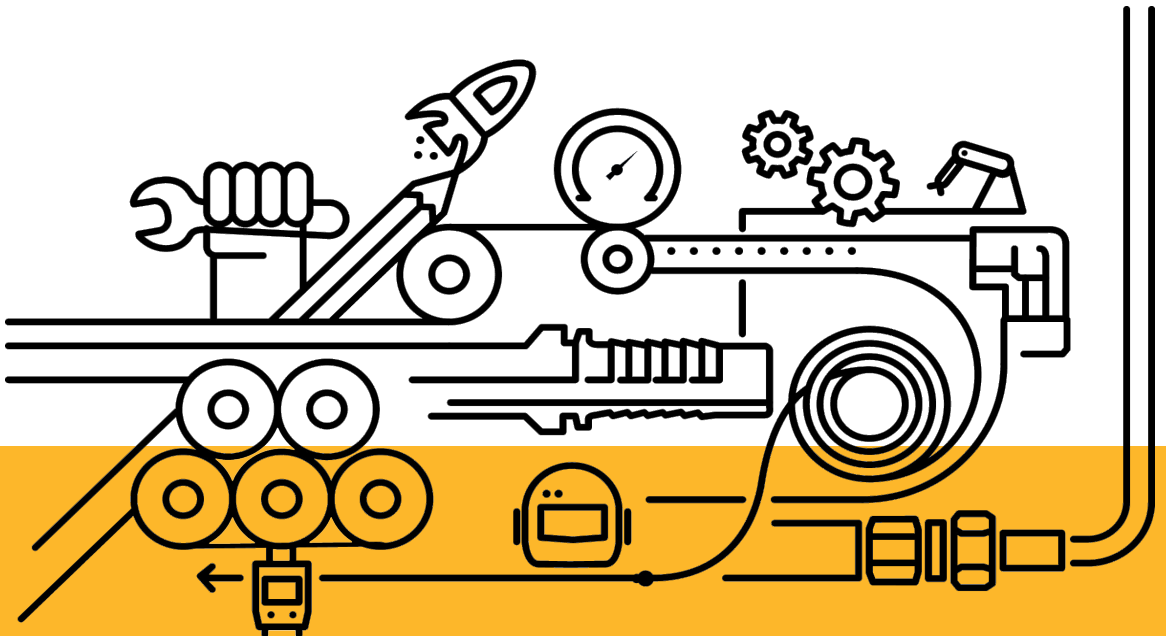



# Vitillo

Hydraulic Components



We feel better under pressure

## Hoses



## Press fittings ISO 12151 SAE J516



## BSP adaptors BS 5200



## JIC adaptors SAE J514



## DIN 24° adaptors DIN 2353



## ORFS adaptors ORFS J1453



# Kompletna oferta produktowa

Vitillo jest rozwiązaniem na wszystkie problemy związane z zastosowaniem hydrauliki siłowej.

Węże spiralne i plecione z metalowym opłotem, końcówki standardowe, interlock, BSP, JIC, ORFS i specjalne.

Wszystkie końcówki dostępne w wersjach: Zinc chromium III plating, nikło-ocynk, oraz stal nierdzewna.

Na każde zapytanie klienta, odpowiedzią jest Vitillo.

# Alternatywne wersje

---

## Zinc Chromium III

---

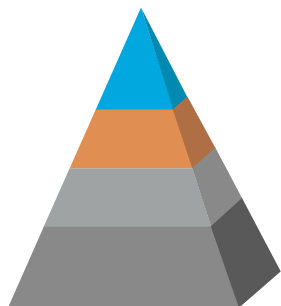

01.Sealing Layer

02.Passivation

03.Zinc Cr III

04.Carbon Steel

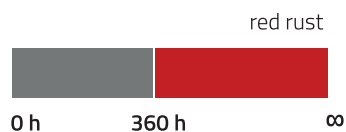

## Niko Ocynki

---

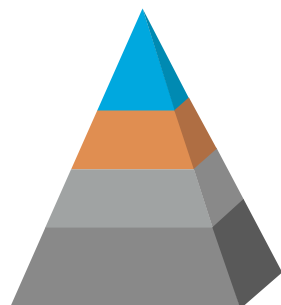

01.Sealing Layer

02.Passivation

03.Zinc Cr III

04.Carbon Steel



## Stal Nierdzewna

---

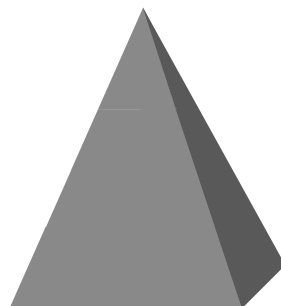

01.Stainless Steel





# Zastosowanie

---



# Wysoka wydajność w ekstremalnych warunkach



# Certyfikaty

---



▼  
MINE SAFETY AND HEALTH  
ADMINISTRATION  
(MSHA)



▼  
DET NORSKE VERITAS (DNV)  
GERMANISCHER LLOYD (GL)



▼  
RINA (Registro Navale Italiano)

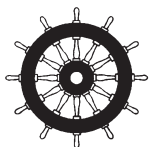

▼  
MarED



▼  
GOST-R



AC 149



HAMILTON

▼  
J.S. Hamilton Poland Sp. z o.o. –  
Jednostka Certyfikująca



▼  
UNI EN 45545-2



COMPONENTS ORFS

**ABO**

BUSH  
/ Pg. 14

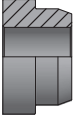

**DBO**

ORFS NUT  
/ Pg. 15

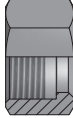

**AMO**

MALE ORFS - MALE ORFS  
/ Pg. 16

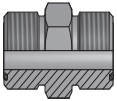

**LMO**

90° MALE EQUAL EL-  
BOW-ORFS MALE  
/ Pg. 17

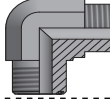

**QMO**

45° MALE ELBOW-ORFS  
MALE  
/ Pg. 18

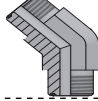

**TMO**

T ADPT MALE ORFS  
/ Pg. 19

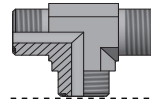

MALE-MALE ORFS

**APPMO**

BULKHEAD CONNECTION  
/ Pg. 20

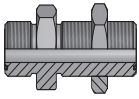

**LPPMO**

90° BULKHEAD-ORFS  
MALE  
/ Pg. 21



**QPPMO**

ORFS MALE BULKHEAD  
ELBOW-ORFS MALE  
/ Pg. 22

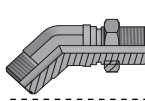

**TPPMO. B**

RUN TEE BULKHEAD MALE  
ORFS / Pg. 23

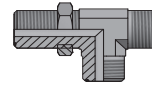

**TPPMO. P**

BRANCH TEE BULKHEAD  
MALE ORFS / Pg. 24

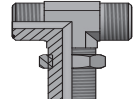

SWIVEL F.-MALE ORFS

**AFGO MO**

ADP SWIVEL FEMAL ORFS  
- MALE ORFS  
/ Pg. 25-26

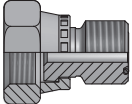

**LMO. FGO**

90° ADAPTOR FEMALE  
ORFS-MALE ORFS  
/ Pg. 27

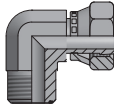

**QMO.FGO**

45° ADAPTOR FEMALE  
ORFS -MALE ORFS  
/ Pg. 28

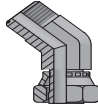

**TMO FGO. B**

RUN FEMALE ORFS-TEE  
MALE ORFS  
/ Pg. 29

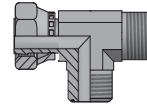

**TMO FGO. P**

BRANCH FEMALE ORFS-  
TEE MALE ORFS  
/ Pg. 30

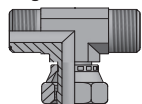

SWIVEL FEMALE ORFS

**AFGO**

FEMALE ORFS -FEMALE  
ORFS  
/ Pg. 31

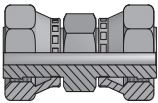

# Visual index

MALE ORFS-MALE BSPP

**AMO MG. R**  
ADP MALE ORFS MALE  
BSPP FORM E  
/ Pg. 32-33

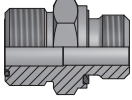

**AMO MG. SV**  
ADP MALE ORFS MALE  
BSPP 60° CONE  
/ Pg. 34

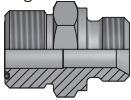

MALE ORFS-F. BSPP

**AMO FFG**  
ADP MALE ORFS - FIXED  
FEMALE BSPP  
/ Pg. 35

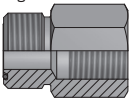

**APPMO FFG**  
STRAIGHT BULKHEAD ADP  
MALE ORFS-FEMALE BSPP  
/ Pg. 36

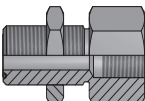

FEMALE ORFS-BSPP

**AFGO FFG**  
ORFS SWIVEL NUT BSPP  
FEMALE  
/ Pg. 37

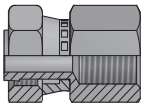

**AFGO MG SV**  
ADP FEMALE ORFS MALE  
BSPP WITH 60° CONE  
/ Pg. 38

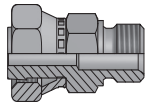

**AFGO MG R**  
ADAPTOR FEMALE ORFS -  
MALE BSPP FORM E  
/ Pg. 39

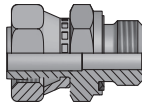

MALE ORFS-M. METRIC

**AMO MM. R**  
ADP MALE ORFS MALE  
METRIC FORM E  
/ Pg. 40-41

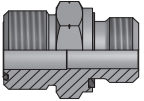

**AMO MM**  
ADP MALE ORFS MALE  
METRIC  
/ Pg. 42

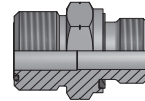

FEMALE ORFS-METRIC

**AFGO FFM**  
ORFS SWIVEL NUT METRIC  
FEMALE  
/ Pg. 43

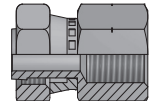

**AFGO MM R**  
ADAPTOR FEMALE ORFS -  
MALE METRIC FORM E  
/ Pg. 44

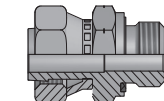

MALE ORFS-MALE UNF

**AMO MU**  
ADP MALE ORFS MALE  
UNF  
/ Pg. 45-46

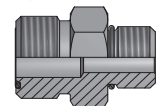

FEMALE ORFS-MALE UNF

**AFGO MU**  
ADAPTOR FEMALE ORFS -  
MALE UNF  
/ Pg. 47

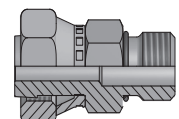

# Visual index

MALE ORFS-MALE NPT

**AMO MN**  
ADP MALE ORFS MALE NPT  
/ Pg. 48

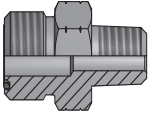

**LMO MN**  
90° ADAPTOR MALE ORFS-  
NPT MALE / Pg. 49

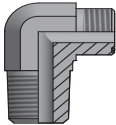

**QMO MN**  
45° ADAPTOR MALE ORFS-  
NPT MALE  
/ Pg. 50

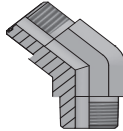

MALE ORFS-FEMALE NPT

**AMO FFN**  
ADP MALE ORFS FIXED  
FEMALE NPT  
/ Pg. 51

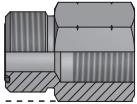

**APPMO FFN**  
STRAIGHT BULKHEAD  
MALE ORFS FEMALE NPT  
/ Pg. 52

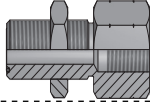

MALE ORFS-MALE DIN

**AMO ME**  
ADP MALE ORFS  
MALE DIN  
/ Pg. 53

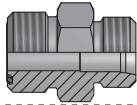

MALE ORFS-FEMALE DIN

**AMO FE**  
ADP MALE ORFS  
FEMALE DIN  
/ Pg. 54

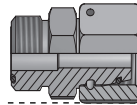

MALE ORFS-MALE JIC

**AMO MJ**  
ADP MALE ORFS  
MALE JIC  
/ Pg. 55

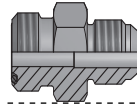

MALE ORFS-FEMALE JIC

**AMO FGJ**  
ADP MALE ORFS  
FEMALE JIC  
/ Pg. 56

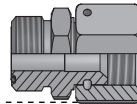

**AFGO MJ**  
ADP FEMALE ORFS  
MALE JIC  
/ Pg. 57

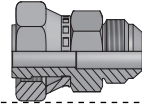

WELD FITTINGS

**AMNST**  
WELDING ADP MALE ORFS  
/ Pg. 58-59-60

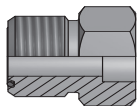

**TO .. W**  
WELDING UNION  
/ Pg. 61

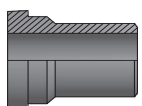

**LMO .. W**  
90° ADP MALE ORFS SIDE  
TO WELD  
/ Pg. 62

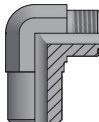

**LMO .. T**  
90° ADP MALE ORFS SIDE  
FEMALE TO WELD  
/ Pg. 63

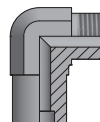

**LMO MOG**

90° ADJUSTABLE MALE  
ORFS- MALE BSPP  
/ Pg. 64-65

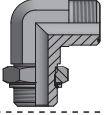
**LMO MOM R**

90° ADJUSTABLE MALE  
ORFS- MALE METRIC  
/ Pg. 66

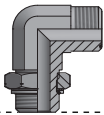
**LMO MOU**

90° ADJUSTABLE MALE  
ORFS- MALE METRIC  
/ Pg. 67-68

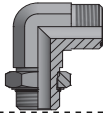
**QMO MOG**

45° ADJUSTABLE MALE  
ORFS- MALE BSPP  
/ Pg. 69-70

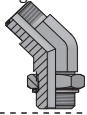
**QMO MOM R**

45° ADJUSTABLE MALE  
ORFS- MALE METRIC  
/ Pg. 71

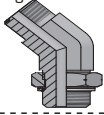
**QMO MOU**

45° ADJUSTABLE MALE  
ORFS- MALE METRIC  
/ Pg. 72-73

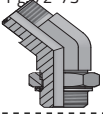
**TMO MOG B**

RUN TEE ADJUSTABLE  
MALE ORFS- MALE BSPP  
/ Pg. 74-75

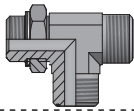
**TMO MOM R B**

RUN TEE ADJUSTABLE  
MALE ORFS- MALE METRIC  
/ Pg. 76

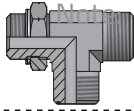
**TMO MOU B**

RUN TEE ADJUSTABLE  
MALE ORFS- MALE METRIC  
/ Pg. 77-78

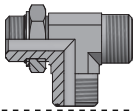
**TMO MOG P**

BRUNCH TEE ADJUSTABLE  
MALE ORFS- MALE BSPP  
/ Pg. 79-80

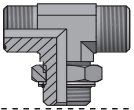
**TMO MOM R P**

BRUNCH TEE ADJUSTABLE  
MALE ORFS- MALE METRIC  
/ Pg. 81

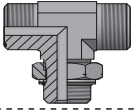
**TMO MOU P**

BRUNCH TEE ADJUSTABLE  
MALE ORFS- MALE METRIC  
/ Pg. 82-83

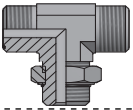

LOCKNUT ADJUSTABLE

**LFGO MOG**

90° FEMALE ORFS- AD-  
JUSTABLE MALE BSPP  
/ Pg. 84

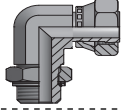
**LFGO MOM R**

90° FEMALE ORFS- AD-  
JUSTABLE MALE METRIC  
/ Pg. 85

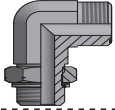
**LFGO MOU**

90° ADJUSTABLE MALE  
ORFS- MALE METRIC  
/ Pg. 86



PLUG

**ATMO**

MALE PLUG UNF  
/ Pg. 87

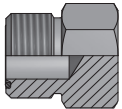
**ATFGO**

FEMALE PLUG UNF  
/ Pg. 88

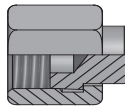

Notatka:

Vitillo Spa oferuje szeroki wachlarz końcówek oraz złączy. Jeśli poszukujesz innej kombinacji gwintów, której tutaj nie znalazłeś, sprawdź również pozostałe katalogi lub zapytaj w naszym Dziale Technicznym.

Np. Dla złączy JIC-BSP sprawdź katalog JIC

**Vitillo Spa offers a wide range of fittings and adaptors. If you have not found here the threads combination you were looking for, please check also in the other catalogues or ask to our Technical Staff.**

**Ex. For adapter Jic to Bsp check Jic Catalog**

## Nut - Bush coupling correspondence

bush D	bush D	Bush CODE	NUT Code
6	1/4	AB006	DB006
8	5/16	AB008	DB009
10	3/8	AB010	DB009
12	1/2	AB012	DB011
14	-	AB014	DB013
15	-	AB015	DB013
16	5/8	AB016	DB013
18		AB018	DB014
20	3/4	AB020	DB014
22	7/8	AB022	DB015
25	1	AB025	DB015
28		AB028	DB021
30	1.1/4	AB030	DB021
32		AB032	DB021
35		AB035	DB032
38	1.1/2	AB038	DB032

## BUSH DLA ORFS

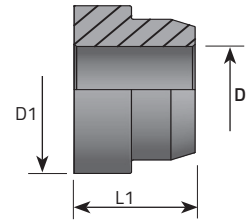

Code	Thread	Dimensions				Pressure
		D	D	D1	L1	
		in	mm	mm	mm	
AB006		1/4	6	12.75	7.5	
<b>AB008</b>		<b>5/16</b>	<b>8</b>	<b>15.75</b>	<b>8.5</b>	
AB010		3/8	10	15.75	8.5	
<b>AB012</b>		<b>1/2</b>	<b>12</b>	<b>18.9</b>	<b>10.5</b>	
AB014		-	14	23.45	10.5	
<b>AB015</b>		-	<b>15</b>	<b>23.45</b>	<b>10.5</b>	
AB016		5/8	16	23.45	10.5	
<b>AB018</b>		-	<b>18</b>	<b>27.85</b>	<b>12</b>	
AB020		3/4	20	27.85	12	
<b>AB022</b>		<b>7/8</b>	<b>22</b>	<b>34.2</b>	<b>13.5</b>	
AB025		1	25	34.2	13.5	
<b>AB028</b>		-	<b>28</b>	<b>40.55</b>	<b>13</b>	
AB030		1.1/4	30	40.55	13	
<b>AB032</b>		-	<b>32</b>	<b>40.55</b>	<b>13</b>	
AB035		-	35	48.5	12.5	
<b>AB038</b>		<b>1.1/2</b>	<b>38</b>	<b>48.5</b>	<b>12.5</b>	

## ORFS NAKRĘTKA

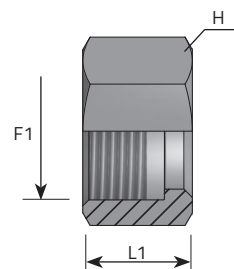

F1 ORFS

Code	Thread	Dimensions		Pressure
		H	L1	
	F1	H	L1	
	in	mm	mm	
DB006	9/16"	17	15	
DB009	11/16"	22	17	
DB011	13/16"	24	20	
DB013	1"	30	24	
DB014	1.3/16"	36	26.5	
DB015	1.7/16"	41	27.5	
DB021	1.11/16"	50	27.5	
DB032	2"	60	27.5	

## ZŁĄCZKA MĘSKA ORFS - MĘSKA ORFS

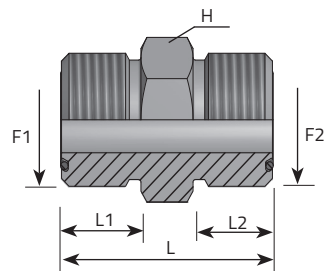

Code	Thread		Dimensions				Pressure	
	F1	F2	H	L1	L2	L	Bar	Psi
	in	in	mm	mm	mm	mm		
AMO0606	9/16	9/16	17	10	10	27.5	630	9136
<b>AMO0909</b>	<b>11/16</b>	<b>11/16</b>	<b>19</b>	<b>11</b>	<b>11</b>	<b>31</b>	<b>630</b>	<b>9136</b>
AMO1111	13/16	13/16	22	13	13	35.5	630	9136
<b>AMO1313</b>	<b>1</b>	<b>1</b>	<b>27</b>	<b>15.5</b>	<b>15.5</b>	<b>42.5</b>	<b>420</b>	<b>6091</b>
AMO1414	1.3/16	1.3/16	32	17	17	47	420	6091
<b>AMO1515</b>	<b>1.7/16</b>	<b>1.7/16</b>	<b>41</b>	<b>17.5</b>	<b>17.5</b>	<b>49.5</b>	<b>420</b>	<b>6091</b>
AMO2121	1.11/16	1.11/16	46	17.5	17.5	51.5	280	4060
<b>AMO3232</b>	<b>2</b>	<b>2</b>	<b>55</b>	<b>17.5</b>	<b>17.5</b>	<b>53</b>	<b>280</b>	<b>4060</b>
AMO0906	11/16	9/16	19	11	10	30	630	9136
<b>AMO1109</b>	<b>13/16</b>	<b>11/16</b>	<b>22</b>	<b>13</b>	<b>11</b>	<b>33.5</b>	<b>630</b>	<b>9136</b>
AMO1311	1	13/16	27	15.5	13	40	420	6091
<b>AMO1409</b>	<b>1.3/16</b>	<b>11/16</b>	<b>32</b>	<b>17</b>	<b>11</b>	<b>41</b>	<b>420</b>	<b>6091</b>
AMO1411	1.3/16	13/16	32	17	13	43	420	6091
<b>AMO1413</b>	<b>1.3/16</b>	<b>1</b>	<b>32</b>	<b>17</b>	<b>15.5</b>	<b>45.5</b>	<b>420</b>	<b>6091</b>
AMO1514	1.7/16	1.3/16	41	17.5	17	49	420	6091
<b>AMO2115</b>	<b>1.11/16</b>	<b>1.7/16</b>	<b>46</b>	<b>17.5</b>	<b>17.5</b>	<b>51.5</b>	<b>280</b>	<b>4060</b>



## 90° ZŁĄCZKA MĘSKA ORFS - MĘSKA ORFS

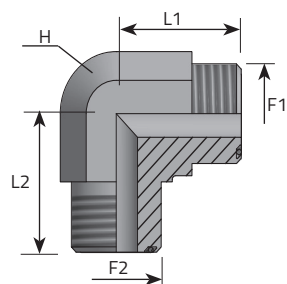

Code	Thread		Dimensions			Pressure	
	F1 in	F2 in	H mm	L1 mm	L2 mm	Bar	Psi
LM00606	9/16	9/16	14	21.5	21.5	630	9136
<b>LM00909</b>	<b>11/16</b>	<b>11/16</b>	<b>19</b>	<b>25</b>	<b>25</b>	<b>630</b>	<b>9136</b>
LM01111	13/16	13/16	22	28	28	630	9136
<b>LM01313</b>	<b>1</b>	<b>1</b>	<b>27</b>	<b>33.5</b>	<b>33.5</b>	<b>420</b>	<b>6091</b>
LM01414	1.3/16	1.3/16	30	37.5	37.5	420	6091
<b>LM01515</b>	<b>1.7/16</b>	<b>1.7/16</b>	<b>36</b>	<b>41.5</b>	<b>41.5</b>	<b>420</b>	<b>6091</b>
LM02121	1.11/16	1.11/16	41	52	52	280	4060
<b>LM03232</b>	<b>2</b>	<b>2</b>	<b>48</b>	<b>49</b>	<b>49</b>	<b>280</b>	<b>4060</b>
LM00609	9/16	11/16	19	25	23.5	630	9136
<b>LM00911</b>	<b>11/16</b>	<b>13/16</b>	<b>19</b>	<b>28</b>	<b>25</b>	<b>630</b>	<b>9136</b>
LM01113	13/16	1	27	33.5	31.5	420	6091
<b>LM00914</b>	<b>11/16</b>	<b>1.3/16</b>	<b>30</b>	<b>37.5</b>	<b>32.5</b>	<b>420</b>	<b>6091</b>
LM01114	13/16	1.3/16	30	37.5	34.5	420	6091
<b>LM01314</b>	<b>1</b>	<b>1.3/16</b>	<b>30</b>	<b>37.5</b>	<b>36.5</b>	<b>420</b>	<b>6091</b>
LM01415	1.3/16	1.7/16	36	41.5	41	420	6091
<b>LM01521</b>	<b>1.7/16</b>	<b>1.11/16</b>	<b>41</b>	<b>52</b>	<b>52</b>	<b>280</b>	<b>4060</b>

## 45° ZŁĄCZKA MĘSKA ORFS - MĘSKA ORFS

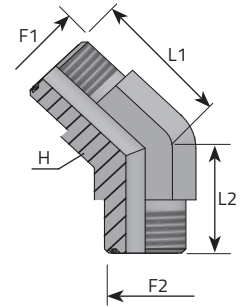

Code	Thread		Dimensions			Pressure	
	F1 in	F2 in	H mm	L1 mm	L2 mm	Bar	Psi
QMO0606	9/16	9/16	14	16	16	630	9136
QMO0909	11/16	11/16	19	19	19	630	9136
QMO1111	13/16	13/16	22	20.5	20.5	630	9136
QMO1313	1	1	27	23.5	23.5	420	6091
QMO1414	1.3/16	1.3/16	30	26	26	420	6091
QMO1515	1.7/16	1.7/16	36	30	30	420	6091
QMO2121	1.11/16	1.11/16	41	32	32	280	4060
QMO3232	2	2	48	37	37	280	4060

## TRÓJNIK ZŁĄCZKA MĘSKA ORFS

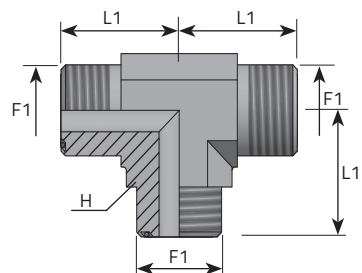

Code	Thread	Dimensions		Pressure	
		H	L1	Bar	Psi
	F1				
	in	mm	mm		
TM00606	9/16	14	21.5	630	9136
<b>TM00909</b>	<b>11/16</b>	<b>19</b>	<b>25</b>	<b>630</b>	<b>9136</b>
TM01111	13/16	22	28	630	9136
<b>TM01313</b>	<b>1</b>	<b>27</b>	<b>33.5</b>	<b>420</b>	<b>6091</b>
TM01414	1.3/16	30	37.5	420	6091
<b>TM01515</b>	<b>1.7/16</b>	<b>36</b>	<b>41.5</b>	<b>420</b>	<b>6091</b>
TM02121	1.11/16	41	44.5	280	4060
<b>TM03232</b>	<b>2</b>	<b>48</b>	<b>49</b>	<b>280</b>	<b>4060</b>

## PROSTA GRODZIOWA ZŁĄCZKA MĘSKA ORFS

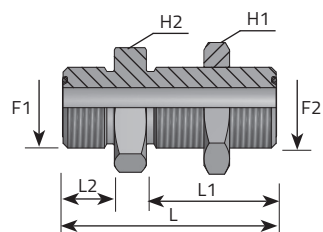

Code	Thread		Dimensions					Pressure	
	F1	F2	H	H1	L2	L1	L	Bar	Psi
	in	in	mm	mm	mm	mm	mm		
APPM00606	9/16	9/16	22	22	31.5	10	48	630	9136
APPM00909	11/16	11/16	27	27	34	11	53	630	9136
APPM01111	13/16	13/16	30	30	36.5	13	58,5	630	9136
APPM01313	1	1	36	36	40.5	15.5	66,5	420	6091
APPM01414	1.3/16	1.3/16	41	41	41.5	17	69	420	6091
APPM01515	1.7/16	1.7/16	46	46	42	17.5	70	280	4060
APPM02121	1.11/16	1.11/16	50	50	42	17.5	70	280	4060
APPM03232	2	2	60	60	42	17.5	70	280	4060

## 90° GRODZIOWA ZŁĄCZKA MĘSKA ORFS - MĘSKA ORFS

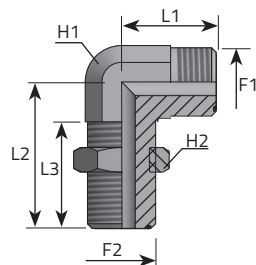

Code	Thread		Dimensions					Pressure	
	F1 in	F2 in	H1 mm	H2 mm	L1 mm	L2 mm	L3 mm	Bar	Psi
LPPMO0606	9/16	9/16	14	22	21.5	47	31.5	630	9136
LPPMO0909	11/16	11/16	19	27	25	52	34	630	9136
LPPMO1111	13/16	13/16	22	30	28	55.5	36.5	630	9136
LPPMO1313	1	1	27	36	33.5	63	40.5	420	6091
LPPMO1414	1.3/16	1.3/16	33	41	42	67	41.5	420	6091
LPPMO1515	1.7/16	1.7/16	36	46	45.5	75	43	420	6091
LPPMO2121	1.11/16	1.11/16	41	50	52	75.5	42	280	4060
LPPMO3232	2	2	48	60	49	79.5	42	280	4060

## 45° GRODZIOWA ZŁĄCZKA MĘSKA ORFS - MĘSKA ORFS

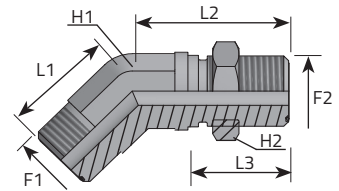

Code	Thread		Dimensions					Pressure	
	F1	F2	H1	H2	L1	L2	L3	Bar	Psi
	in	in	mm	mm	mm	mm	mm		
QPPM00606	9/16	9/16	14	22	16	44	31.5	630	9136
QPPM00909	11/16	11/16	19	27	19	48.5	34	630	9136
QPPM01111	13/16	13/16	22	30	20.5	51	36.5	630	9136
QPPM01313	1	1	27	36	23.5	56.5	40.5	420	6091
QPPM01414	1.3/16	1.3/16	30	41	26	60.5	41.5	420	6091
QPPM01515	1.7/16	1.7/16	36	46	30	65	42	420	6091
QPPM02121	1.11/16	1.11/16	41	50	32	67	42	280	4060
QPPM03232	2	2	48	60	37	67	42	280	4060

## TRÓJNIK ZŁĄCZKA GRODZIOWA MĘSKA ORFS - MĘSKA ORFS

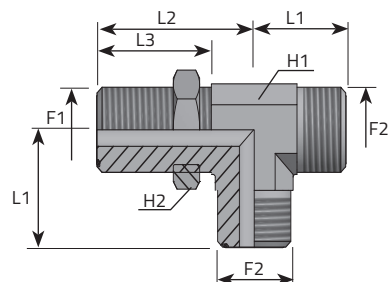

Code	Thread		Dimensions					Pressure	
	F1 in	F2 in	H1 mm	H2 mm	L1 mm	L2 mm	L3 mm	Bar	Psi
TPPMO0606B	9/16	9/16	14	22	21.5	47	31.5	630	9136
TPPMO0909B	11/16	11/16	19	27	25	52	34	630	9136
TPPMO1111B	13/16	13/16	22	30	28	55.5	36.5	630	9136
TPPMO1313B	1	1	27	36	33.5	63	40.5	420	6091
TPPMO1414B	1.3/16	1.3/16	30	41	37.5	67	41.5	420	6091
TPPMO1515B	1.7/16	1.7/16	36	46	41.5	71	42	420	6091
TPPMO2121B	1.11/16	1.11/16	41	50	44.5	75.5	42	280	4060
TPPMO3232B	2	2	48	60	49	79.5	42	280	4060

## TRÓJNIK ZŁĄCZKA GRODZIOWA MĘSKA ORFS - MĘSKA ORFS

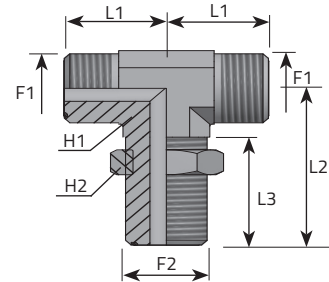

Code	Thread		Dimensions					Pressure	
	F1	F2	H1	H2	L1	L2	L3	Bar	Psi
	in	in	mm	mm	mm	mm	mm		
TPPM00606P	9/16	9/16	14	22	21.5	47	31.5	630	9136
TPPM00909P	11/16	11/16	19	27	25	52	34	630	9136
TPPM01111P	13/16	13/16	22	30	28	55.5	36.5	630	9136
TPPM01313P	1	1	27	36	33.5	63	40.5	420	6091
TPPM01414P	1.3/16	1.3/16	30	41	37.5	67	41.5	420	6091
TPPM01515P	1.7/16	1.7/16	36	46	41.5	71	42	420	6091
TPPM02121P	1.11/16	1.11/16	41	50	44.5	75.5	42	280	4060
TPPM03232P	2	2	48	60	49	79.5	42	280	4060



## ZŁĄCZKA OBROTOWA ZEŃSKA ORFS - MĘSKA ORFS (1)

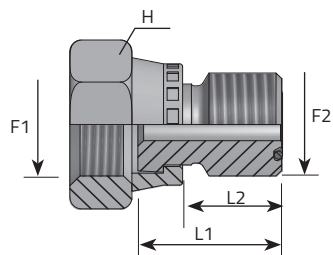

Code	Thread		Dimensions			Pressure		
	F1 in	F2 in	H mm	L1 mm	L2 mm	form	Bar	Psi
AFGO09M006	11/16	9/16	22	20	10	X	630	9136
AFGO11M006	13/16	9/16	24	22	10	Y	630	9136
AFGO13M006	1	9/16	30	23	10	Y	420	6091
AFGO14M006	1.3/16	9/16	36	25	10	Y	420	6091
AFGO15M006	1.7/16	9/16	41	26	10	Y	420	6091
AFGO21M006	1.11/16	9/16	50	26.5	10	Y	280	4060
AFGO32M006	2	9/16	60	26.5	10	Y	280	4060
AFGO11M009	13/16	11/16	24	23	11	X	630	9136
AFGO13M009	1	11/16	30	24	11	Y	420	6091
AFGO14M009	1.3/16	11/16	36	26	11	Y	420	6091
AFGO15M009	1.7/16	11/16	41	27	11	Y	420	6091
AFGO21M009	1.11/16	11/16	50	27.5	11	Y	280	4060
AFGO32M009	2	11/16	60	27.5	11	Y	280	4060

**X: Version with crimped nut**  
Wersja z nakrętką zaciskaną

**Y: Version with slip back nut**  
Wersja z nakrętką nakładaną

## ZŁĄCZKA OBROTOWA ZEŃSKA ORFS - MĘSKA ORFS (2)

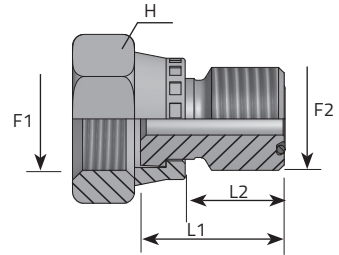

Code	Thread		Dimensions			Pressure		
	F1 in	F2 in	H mm	L1 mm	L2 mm	form	Bar	Psi
AFGO13M011	1	13/16	30	25.5	13	Y	420	6091
AFGO14M011	1.3/16	13/16	36	27.5	13	Y	420	6091
* AFGO14M015	1.3/16	1.7/16	36	58	17.5	z	420	6091
AFGO15M011	1.7/16	13/16	41	29	13	Y	420	6091
* AFGO15M021	1.7/16	1.11/16	41	60.5	17.5	z	420	6091
AFGO21M011	1.11/16	13/16	50	29.5	13	Y	280	4060
AFGO32M011	2	13/16	60	29.5	13	Y	280	4060
AFGO14M013	1.3/16	1	36	29.5	15.5	X	420	6091
AFGO14M015	1.3/16	1.7/16	41	32	17.5	X	420	6091
AFGO15M013	1.7/16	1	41	32	15.5	Y	420	6091
AFGO15M021	1.7/16	1.11/16	46	33.5	17.5	X	420	6091
AFGO21M013	1.11/16	1	50	32	15.5	Y	280	4060
AFGO32M013	2	1	60	32	15.5	Y	280	4060
AFGO15M014	1.7/16	1.3/16	41	33	17	Y	420	6091
AFGO21M014	1.11/16	1.3/16	50	33.5	17	Y	280	4060
AFGO32M014	2	1.3/16	60	33.5	17	Y	280	4060
AFGO21M015	1.11/16	1.7/16	50	34	17.5	X	280	4060
AFGO32M015	2	1.7/16	60	34	17.5	Y	280	4060
AFGO32M021	2	1.11/16	60	34	17.5	Y	280	4060

**X: Version with crimped nut**

Wersja z nakrętką zaciskaną

**Y: Version with slip back nut**

Wersja z nakrętką nakładaną

**Z: Double hexagon version**

Wersja z podwójnym sześciokątem

## 90° ZŁĄCZKA ZEŃSKA ORFS - MĘSKA ORFS

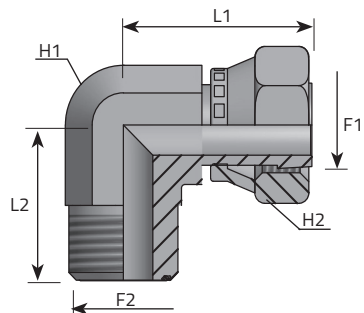

Code	Thread		Dimensions				Pressure	
	F1	F2	H1	H2	L1	L2	Bar	Psi
	in	in	mm	mm	mm	mm		
LMO06FG006	9/16	9/16	14	17	26.5	21.5	420	6091
LMO09FG009	11/16	11/16	19	22	29	25	420	6091
LMO11FG011	13/16	13/16	22	24	38	28	420	6091
LMO13FG013	1	1	27	30	41	33.5	420	6091
LMO14FG014	1.3/16	1.3/16	30	36	46.5	37.5	420	6091
LMO15FG015	1.7/16	1.7/16	36	41	53.5	41.5	380	5511
LMO21FG021	1.11/16	1.11/16	41	50	58	44.5	280	4060
LMO32FG032	2	2	48	60	61	49	280	4060

## 45° ZŁĄCZKA ZEŃSKA ORFS - MĘSKA ORFS

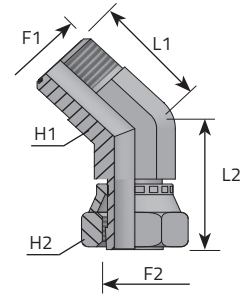

Code	Thread		Dimensions				Pressure	
	F1	F2	H1	H2	L1	L2	Bar	Psi
	in	in	mm	mm	mm	mm		
QMO06FG006	9/16	9/16	14	17	16	26.5	630	9136
QMO09FG009	11/16	11/16	19	22	19	29	630	9136
QMO11FG011	13/16	13/16	22	24	20.5	38	630	9136
QMO13FG013	1	1	27	30	23.5	41	420	6091
QMO14FG014	1.3/16	1.3/16	30	36	26	46.5	420	6091
QMO15FG015	1.7/16	1.7/16	36	41	30	53.5	420	6091
QMO21FG021	1.11/16	1.11/16	41	50	32	58	280	4060
QMO32FG032	2	2	48	60	37	61	280	4060

## ZEŃSKA ORFS-TRÓJNIK MĘSKI ORFS - TRÓJNIK MĘSKI ORFS

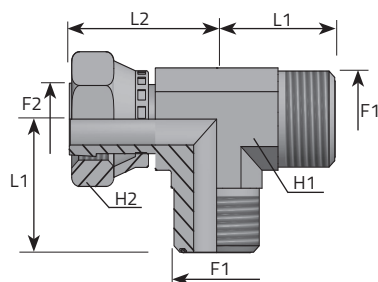

Code	Thread		Dimensions				Pressure	
	F1 in	F2 in	H1 mm	H2 mm	L1 mm	L2 mm	Bar	Psi
TMO06FG006B	9/16	9/16	14	17	21.5	26.5	630	9136
<b>TMO09FG009B</b>	<b>11/16</b>	<b>11/16</b>	<b>19</b>	<b>22</b>	<b>25</b>	<b>29</b>	<b>630</b>	<b>9136</b>
TMO11FG011B	13/16	13/16	22	24	28	38	630	9136
<b>TMO13FG013B</b>	<b>1</b>	<b>1</b>	<b>27</b>	<b>30</b>	<b>33.5</b>	<b>41</b>	<b>420</b>	<b>6091</b>
TMO14FG014B	1.3/16	1.3/16	30	36	37.5	46.5	420	6091
<b>TMO15FG015B</b>	<b>1.7/16</b>	<b>1.7/16</b>	<b>36</b>	<b>41</b>	<b>41.5</b>	<b>53.5</b>	<b>420</b>	<b>6091</b>
TMO21FG021B	1.11/16	1.11/16	41	50	44.5	58	280	4060
<b>TMO32FG032B</b>	<b>2</b>	<b>2</b>	<b>48</b>	<b>60</b>	<b>49</b>	<b>61</b>	<b>280</b>	<b>4060</b>

## TRÓJNIK MĘSKI ORFS - TRÓJNIK MĘSKI ORFS - ZEŃSKA ORFS

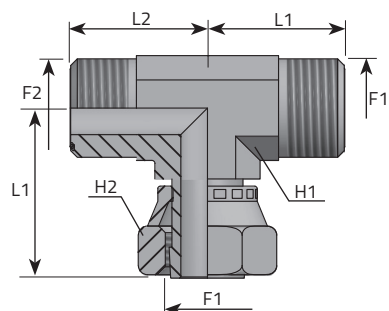

Code	Thread		Dimensions				Pressure	
	F1 in	F2 in	H1 mm	H2 mm	L1 mm	L2 mm	Bar	Psi
TMO06FG006P	9/16	9/16	14	17	21.5	26.5	630	9136
TMO09FG009P	11/16	11/16	19	22	25	29	630	9136
TMO11FG011P	13/16	13/16	22	24	28	38	630	9136
TMO13FG013P	1	1	27	30	33.5	41	420	6091
TMO14FG014P	1.3/16	1.3/16	30	36	37.5	46.5	420	6091
TMO15FG015P	1.7/16	1.7/16	36	41	41.5	53.5	420	6091
TMO21FG021P	1.11/16	1.11/16	41	50	44.5	58	280	4060
TMO32FG032P	2	2	48	60	49	61	280	4060

## ZŁĄCZKA ZEŃSKA ORFS - ZEŃSKA ORFS

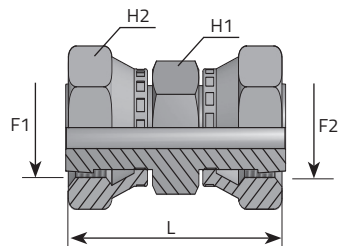

Code	Thread		Dimensions			Pressure	
	F1 in	F2 in	H1 mm	H2 mm	L mm	Bar	Psi
AFG006	9/16	9/16	17	17	39.5	630	9136
<b>AFG009</b>	<b>11/16</b>	<b>11/16</b>	<b>19</b>	<b>22</b>	<b>45</b>	<b>630</b>	<b>9136</b>
AFG011	13/16	13/16	22	24	51.5	630	9136
<b>AFG013</b>	<b>1</b>	<b>1</b>	<b>27</b>	<b>30</b>	<b>61.5</b>	<b>420</b>	<b>6091</b>
AFG014	1.3/16	1.3/16	32	36	68	420	6091
<b>AFG015</b>	<b>1.7/16</b>	<b>1.7/16</b>	<b>41</b>	<b>41</b>	<b>71.5</b>	<b>420</b>	<b>6091</b>
AFG021	1.11/16	1.11/16	46	50	73.5	280	4060
<b>AFG032</b>	<b>2</b>	<b>2</b>	<b>55</b>	<b>60</b>	<b>75</b>	<b>280</b>	<b>4060</b>

## ZŁĄCZKA MĘSKA ORFS - MĘSKA BSPP (1)

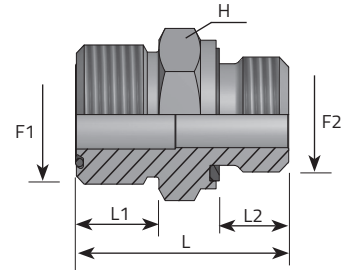

Code	Thread		Dimensions				Pressure	
	F1	F2	H	L1	L2	L	Bar	Psi
	in	in	mm	mm	mm	mm		
AM006MG02R	9/16"	1/8"	17	10	8	25.5	630	9136
<b>AM009MG04R</b>	<b>11/16"</b>	<b>1/4"</b>	<b>19</b>	<b>11</b>	<b>12</b>	<b>32</b>	<b>630</b>	<b>9136</b>
AM011MG06R	13/16"	3/8"	22	13	12	34.5	630	9136
AM013MG08R	1"	1/2"	27	15.5	14	41	420	6091
AM014MG12R	1.3/16"	3/4"	32	17	16	46	420	6091
AM015MG16R	1.7/16"	1"	41	17.5	18	50	420	6091
AM021MG20R	1.11/16"	1.1/4"	50	17.5	20	54	280	4060
AM032MG24R	2"	1.1/2"	55	17.5	22	57.5	280	4060
AM006MG04R	9/16"	1/4"	19	10	12	31	630	9136
AM006MG06R	9/16"	3/8"	22	10	12	31.5	630	9136
AM006MG08R	9/16"	1/2"	27	10	14	35.5	630	9136
AM009MG02R	11/16"	1/8"	19	11	8	27.5	630	9136
AM009MG06R	11/16"	3/8"	22	11	12	32.5	630	9136
AM009MG08R	11/16"	1/2"	27	11	14	36.5	630	9136
AM009MG12R	11/16"	3/4"	32	11	16	40	420	6091
AM011MG04R	13/16"	1/4"	22	13	12	41	630	9136
AM011MG08R	13/16"	1/2"	27	13	14	44	630	9136
AM011MG12R	13/16"	3/4"	32	13	16	46	420	6091



## ZŁĄCZKA MĘSKA ORFS - MĘSKA BSPP (2)

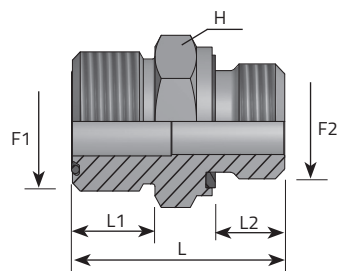

Code	Thread		Dimensions				Pressure	
	F1	F2	H	L1	L2	L	Bar	Psi
	in	in	mm	mm	mm	mm		
AMO13MG04R	1	1/4	27	15.5	12	38	420	6091
<b>AMO13MG06R</b>	<b>1</b>	<b>3/8</b>	<b>27</b>	<b>15.5</b>	<b>12</b>	<b>38.5</b>	<b>420</b>	<b>6091</b>
AMO13MG12R	1	3/4	32	15.5	16	44.5	420	6091
<b>AMO13MG16R</b>	<b>1</b>	<b>1</b>	<b>41</b>	<b>15.5</b>	<b>18</b>	<b>48</b>	<b>420</b>	<b>6091</b>
AMO14MG04R	1.3/16	1/4	32	17	12	41	420	6091
<b>AMO14MG08R</b>	<b>1.3/16</b>	<b>1/2</b>	<b>32</b>	<b>17</b>	<b>14</b>	<b>44</b>	<b>420</b>	<b>6091</b>
AMO14MG16R	1.3/16	1	41	17	18	49.5	420	6091
<b>AMO14MG20R</b>	<b>1.3/16</b>	<b>1.1/4</b>	<b>50</b>	<b>17</b>	<b>20</b>	<b>53.5</b>	<b>420</b>	<b>6091</b>
AMO15MG04R	1.7/16	1/4	41	17.5	12	43	420	6091
<b>AMO15MG06R</b>	<b>1.7/16</b>	<b>3/8</b>	<b>41</b>	<b>17.5</b>	<b>12</b>	<b>43.5</b>	<b>420</b>	<b>6091</b>
AMO15MG12R	1.7/16	3/4	41	17.5	16	48	420	6091
AMO15MG20R	1.7/16	1.1/4	50	17.5	20	54	420	6091
<b>AMO15MG24R</b>	<b>1.7/16</b>	<b>1.1/2</b>	<b>55</b>	<b>17.5</b>	<b>22</b>	<b>57.5</b>	<b>280</b>	<b>4060</b>
AMO21MG16R	1.11/16	1	46	17.5	18	52	280	4060
<b>AMO21MG24R</b>	<b>1.11/16</b>	<b>1.1/2</b>	<b>55</b>	<b>17.5</b>	<b>22</b>	<b>57.5</b>	<b>280</b>	<b>4060</b>

## ZŁĄCZKA MĘSKA ORFS - MĘSKA BSPP ZE STOŻKIEM 60°

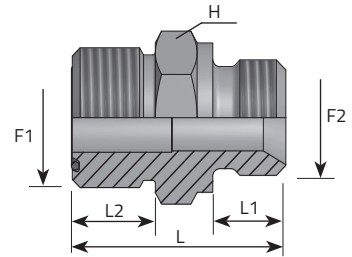

Code	Thread		Dimensions				Pressure	
	F1	F2	H	L1	L2	L	Bar	Psi
	in	in	mm	mm	mm	mm		
AMO06MG02SV	9/16	1/8	17	8	10	25.5	400	5801
<b>AMO09MG04SV</b>	<b>11/16</b>	<b>1/4</b>	<b>19</b>	<b>11</b>	<b>11</b>	<b>32</b>	<b>400</b>	<b>5801</b>
AMO11MG06SV	13/16	3/8	22	12	13	34.5	400	5801
AMO13MG08SV	1	1/2	27	14	15.5	41	350	5076
AMO14MG12SV	1.3/16	3/4	32	16	17	46	315	4568
AMO15MG16SV	1.7/16	1	41	19	17.5	51	250	3625
AMO21MG20SV	1.11/16	1.1/4	50	20	17.5	54	200	2900
AMO32MG24SV	2	1.1/2	55	23	17.5	57.5	160	2320
AMO06MG04SV	9/16	1/4	19	11	10	31	400	5801
AMO06MG06SV	9/16	3/8	22	12	10	31.5	400	5801
AMO09MG06SV	11/16	3/8	22	12	11	32.5	400	5801
AMO09MG08SV	11/16	1/2	27	14	11	36.5	350	5076
AMO11MG04SV	13/16	1/4	22	11	13	35	400	5801
AMO11MG08SV	13/16	1/2	27	14	13	38.5	350	5076
AMO11MG12SV	13/16	3/4	32	16	13	42	315	4568
AMO13MG06SV	1	3/8	27	12	15.5	38.5	400	5801
AMO13MG10SV	1	5/8	30	16	15.5	43	350	5076
AMO13MG12SV	1	3/4	32	16	15.5	44.5	315	4568
AMO14MG08SV	1.3/16	1/2	32	14	17	44	350	5076
AMO14MG16SV	1.3/16	1	41	19	17	50.5	250	3625
AMO15MG12SV	1.7/16	3/4	41	16	17.5	51	315	4568
AMO15MG20SV	1.7/16	1.1/4	50	20	17.5	54	200	2900

## ZŁĄCZKA MĘSKA ORFS - STAŁA ZEŃSKA BSPP

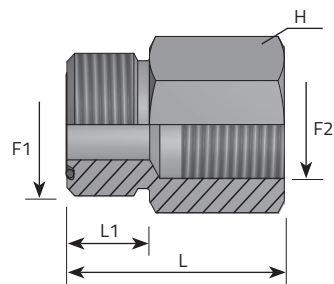

Code	Thread		Dimensions			Pressure	
	F1 in	F2 in	H mm	L1 mm	L mm	Bar	Psi
AM006FFG04	9/16	1/4	19	10	31	630	9136
<b>AM009FFG04</b>	<b>11/16</b>	<b>1/4</b>	<b>19</b>	<b>11</b>	<b>32</b>	<b>630</b>	<b>9136</b>
AM011FFG06	13/16	3/8	24	13	35	630	9136
<b>AM013FFG08</b>	<b>1</b>	<b>1/2</b>	<b>30</b>	<b>15.5</b>	<b>41,5</b>	<b>420</b>	<b>6091</b>
AM014FFG12	1.3/16	3/4	36	17	46	420	6091
<b>AM015FFG16</b>	<b>1.7/16</b>	<b>1</b>	<b>41</b>	<b>17.5</b>	<b>48,5</b>	<b>420</b>	<b>6091</b>
AM021FFG20	1.11/16	1.1/4	55	17.5	53,5	280	4060
<b>AM032FFG24</b>	<b>2</b>	<b>1.1/2</b>	<b>60</b>	<b>17.5</b>	<b>55,5</b>	<b>280</b>	<b>4060</b>
AM011FFG04	13/16	1/4	22	13	34	630	9136
<b>AM014FFG08</b>	<b>1.3/16</b>	<b>1/2</b>	<b>32</b>	<b>17</b>	<b>43</b>	<b>420</b>	<b>6091</b>

## PROSTA GRODZIOWA ZŁĄCZKA MĘSKA ORFS - ZEŃSKA BSPP

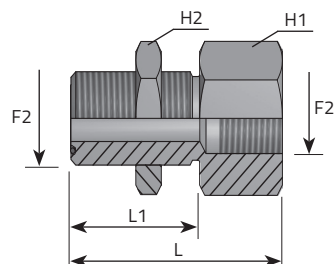

Code	Thread		Dimensions				Pressure	
	F1	F2	H1	H2	L1	L	Bar	Psi
	in	in	mm	mm	mm	mm		
APPM006FFG04	9/16	1/4	22	22	31.5	52.5	630	9136
APPM009FFG04	11/16	1/4	27	27	34	55	630	9136
APPM011FFG06	13/16	3/8	30	30	36.5	58.5	630	9136
APPM013FFG08	1	1/2	36	36	40.5	66.5	420	6091
APPM014FFG12	1.3/16	3/4	41	41	41.5	70.5	420	6091
APPM015FFG16	1.7/16	1	46	46	42	73	420	6091
APPM021FFG20	1.11/16	1.1/4	50	50	42	78	280	4060
APPM032FFG24	2	1.1/2	60	60	42	80	280	4060

## ORFS OBROTOWA NAKRĘTKA - BSPP ZEŃSKA

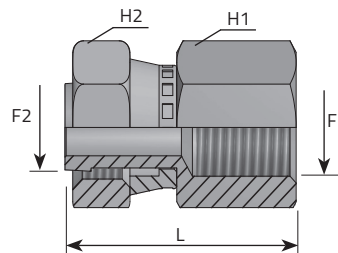

Code	Thread		Dimensions			Pressure	
	F1	F2	H1	H2	L	Bar	Psi
	in	in	mm	mm	mm		
AFGO06FFG04	9/16	1/4	19	17	39	630	9136
<b>AFGO09FFG04</b>	<b>11/16</b>	<b>1/4</b>	<b>19</b>	<b>22</b>	<b>41</b>	<b>630</b>	<b>9136</b>
AFGO11FFG04	13/16	1/4	19	24	43	630	9136
<b>AFGO13FFG04</b>	<b>1</b>	<b>1/4</b>	<b>24</b>	<b>30</b>	<b>46</b>	<b>420</b>	<b>6091</b>
AFGO14FFG04	1.3/16	1/4	30	36	47.5	420	6091
<b>AFGO15FFG04</b>	<b>1.7/16</b>	<b>1/4</b>	<b>36</b>	<b>41</b>	<b>48</b>	<b>420</b>	<b>6091</b>
AFGO21FFG04	1.11/16	1/4	-	50	-	280	4060
<b>AFGO32FFG04</b>	<b>2</b>	<b>1/4</b>	<b>-</b>	<b>60</b>	<b>-</b>	<b>280</b>	<b>4060</b>

## ZŁĄCZKA ZEŃSKA ORFS - MĘSKA BSPP ZE STOŻKIEM 60°

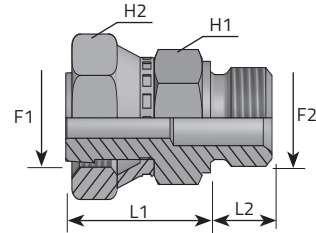

Code	Thread		Dimensions				Pressure	
	F1	F2	H1	H2	L1	L2	Bar	Psi
	in	in	mm	mm	mm	mm		
AFG006MG02SV	9/16	1/8	14	17	25,00	8	400	5801
<b>AFG009MG04SV</b>	<b>11/16</b>	<b>1/4</b>	<b>19</b>	<b>22</b>	<b>29,00</b>	<b>12</b>	<b>400</b>	<b>5801</b>
AFG011MG06SV	13/16	3/8	22	24	35,50	12	400	5801
<b>AFG013MG08SV</b>	<b>1</b>	<b>1/2</b>	<b>27</b>	<b>30</b>	<b>39,50</b>	<b>14</b>	<b>350</b>	<b>5076</b>
AFG014MG12SV	1.3/16	3/4	32	36	41,50	16	315	4568
<b>AFG015MG16SV</b>	<b>1.7/16</b>	<b>1</b>	<b>41</b>	<b>41</b>	<b>46,00</b>	<b>18</b>	<b>250</b>	<b>3625</b>
AFG021MG20SV	1.11/16	1.1/4	50	50	44,50	20	200	2900
<b>AFG032MG24SV</b>	<b>2</b>	<b>1.1/2</b>	<b>55</b>	<b>60</b>	<b>49,50</b>	<b>22</b>	<b>160</b>	<b>2320</b>
AFG006MG04SV	9/16	1/4	19	17	25,50	12	400	5801
<b>AFG006MG06SV</b>	<b>9/16</b>	<b>3/8</b>	<b>22</b>	<b>17</b>	<b>27,50</b>	<b>12</b>	<b>400</b>	<b>5801</b>
AFG009MG06SV	11/16	3/8	22	22	29,50	12	400	5801
<b>AFG009MG08SV</b>	<b>11/16</b>	<b>1/2</b>	<b>27</b>	<b>22</b>	<b>30,50</b>	<b>14</b>	<b>350</b>	<b>5076</b>
AFG011MG04SV	13/16	1/4	19	24	33,50	11	400	5801
<b>AFG011MG08SV</b>	<b>13/16</b>	<b>1/2</b>	<b>27</b>	<b>24</b>	<b>37,00</b>	<b>14</b>	<b>350</b>	<b>5076</b>
AFG011MG12SV	13/16	3/4	32	24	40,50	16	315	4568
<b>AFG013MG06SV</b>	<b>1</b>	<b>3/8</b>	<b>24</b>	<b>30</b>	<b>39,00</b>	<b>12</b>	<b>400</b>	<b>5801</b>
AFG013MG10SV	1	5/8	30	30	39,00	16	350	5076
<b>AFG013MG12SV</b>	<b>1</b>	<b>3/4</b>	<b>32</b>	<b>30</b>	<b>41,00</b>	<b>16</b>	<b>315</b>	<b>4568</b>
AFG014MG08SV	1.3/16	1/2	30	36	43,50	14	350	5076
<b>AFG014MG16SV</b>	<b>1.3/16</b>	<b>1</b>	<b>41</b>	<b>36</b>	<b>44,00</b>	<b>19</b>	<b>250</b>	<b>3625</b>
AFG015MG12SV	1.7/16	3/4	36	41	46,00	16	315	4568
<b>AFG015MG20SV</b>	<b>1.7/16</b>	<b>1.1/4</b>	<b>50</b>	<b>41</b>	<b>47,50</b>	<b>20</b>	<b>200</b>	<b>2900</b>

## ZŁĄCZKA ZEŃSKA ORFS - MĘSKA BSPP

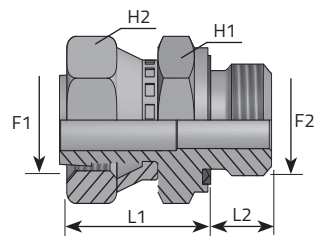

Code	Thread		Dimensions				Pressure	
	F1	F2	H1	H2	L1	L2	Bar	Psi
	in	in	mm	mm	mm	mm		
AFG006MG02R	9/16	1/8	17	17	26.5	8	630	9136
<b>AFG009MG04R</b>	<b>11/16</b>	<b>1/4</b>	<b>19</b>	<b>22</b>	<b>28.5</b>	<b>12</b>	<b>630</b>	<b>9136</b>
AFG011MG06R	13/16	3/8	22	24	35.5	12	630	9136
<b>AFG013MG08R</b>	<b>1</b>	<b>1/2</b>	<b>27</b>	<b>30</b>	<b>38</b>	<b>14</b>	<b>420</b>	<b>6091</b>
AFG014MG12R	1.3/16	3/4	32	36	41.5	16	420	6091
<b>AFG015MG16R</b>	<b>1.7/16</b>	<b>1</b>	<b>41</b>	<b>41</b>	<b>49</b>	<b>18</b>	<b>420</b>	<b>6091</b>
AFG021MG20R	1.11/16	1.1/4	50	50	49	20	280	4060
<b>AFG032MG24R</b>	<b>2</b>	<b>1.1/2</b>	<b>55</b>	<b>60</b>	<b>49</b>	<b>22</b>	<b>280</b>	<b>4060</b>
AFG006MG04R	9/16	1/4	19	17	26.5	12	630	9136
<b>AFG009MG06R</b>	<b>11/16</b>	<b>3/8</b>	<b>22</b>	<b>22</b>	<b>32.5</b>	<b>12</b>	<b>630</b>	<b>9136</b>
AFG011MG08R	13/16	1/2	27	24	34	14	630	9136
<b>AFG014MG20R</b>	<b>1.3/16</b>	<b>1.1/4</b>	<b>50</b>	<b>36</b>	<b>48</b>	<b>20</b>	<b>420</b>	<b>6091</b>

## ZŁĄCZKA MĘSKA ORFS - METRYCZNA MĘSKA (1)

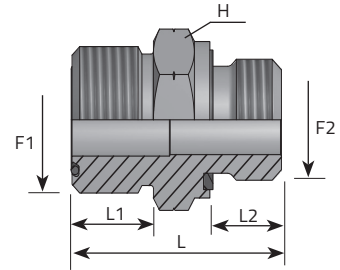

Code	Thread		Dimensions				Pressure	
	F1	F2	H	L1	L2	L	Bar	Psi
	in	mm	mm	mm	mm	mm		
AMO06MM12R	9/16	12X1.5	17	10	12	30	630	9136
<b>AMO09MM14R</b>	<b>11/16</b>	<b>14X1.5</b>	<b>19</b>	<b>11</b>	<b>12</b>	<b>32</b>	<b>630</b>	<b>9136</b>
AMO11MM18R	13/16	18X1.5	24	13	12	34,5	630	9136
AMO13MM22R	1	22X1.5	27	15,5	14	41	420	6091
AMO14MM27R	1.3/16	27X2	32	17	16	46	420	6091
AMO15MM33R	1.7/16	33X2	41	17,5	18	50	420	6091
AMO21MM42R	1.11/16	42X2	50	17,5	20	54	280	4060
AMO32MM48R	2	48X1.5	55	17,5	22	57,5	280	4060
AMO06MM10R	9/16	10X1	17	10	8	25,5	350	5076
AMO06MM14R	9/16	14X1.5	19	10	12	31	630	9136
AMO09MM12R	11/16	12X1.5	19	11	12	32	630	9136
AMO09MM16R	11/16	16X1.5	22	11	12	34	630	9136
AMO09MM18R	11/16	18X1.5	24	11	12	32,5	630	9136
AMO11MM14R	13/16	14X1.5	22	13	12	35	630	9136
AMO11MM16R	13/16	16X1.5	22	13	12	34,5	630	9136
AMO11MM22R	13/16	22X1.5	27	13	14	38,5	630	9136



## ZŁĄCZKA MĘSKA ORFS - METRYCZNA MĘSKA (2)

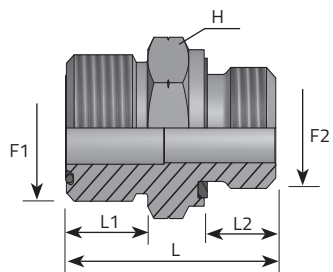

Code	Thread		Dimensions				Pressure	
	F1 in	F2 mm	H mm	L1 mm	L2 mm	L mm	Bar	Psi
AMO13MM18R	1	18x1.5	27	15.5	12	38,5	420	6091
AMO13MM27R	1	27x2	32	15.5	16	44,5	420	6091
AMO14MM22R	1.3/16	22x1.5	32	17	14	44	420	6091
AMO14MM33R	1.3/16	33x2	41	17	18	49,5	420	6091
AMO15MM27R	1.7/16	27x2	41	17.5	16	48	420	6091
AMO15MM42R	1.7/16	42x2	50	17.5	20	54	420	6091
AMO21MM33R	1.11/16	33x2	46	17.5	18	52	280	4060
AMO21MM48R	1.11/16	48x2	55	17.5	22	57,5	280	4060

## ZŁĄCZKA MĘSKA ORFS - METRYCZNA MĘSKA

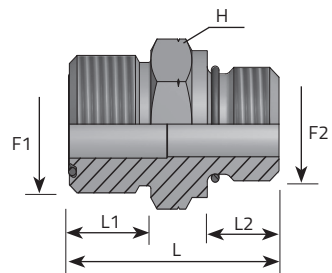

Code	Thread		Dimensions				Pressure	
	F1 in	F2 mm	H mm	L1 mm	L2 mm	L mm	Bar	Psi
AMO09MM14	11/16	14x1.5	19	11	13.5	35	630	9136
<b>AMO09MM12</b>	<b>11/16</b>	<b>12X1.5</b>	<b>22</b>	<b>13</b>	<b>13.5</b>	<b>32</b>	<b>630</b>	<b>9136</b>
AMO11MM22	13/16	22X1.5	22	13	17	38.5	630	9136
<b>AMO14MM22</b>	<b>1.3/16</b>	<b>22X1.5</b>	<b>32</b>	<b>17</b>	<b>17</b>	<b>44</b>	<b>630</b>	<b>9136</b>
AMO15MM27	1.7/16	27X2	41	17.5	19	48	420	6091
<b>AMO15MM33</b>	<b>1.7/16</b>	<b>33X2</b>	<b>41</b>	<b>17.5</b>	<b>22</b>	<b>50</b>	<b>420</b>	<b>6091</b>
AMO21MM42	1.11/16	42X2	50	17.5	22	50	280	6091

## ORFS OBROTOWA NAKRĘTKA - METRYCZNA ŻEŃSKA

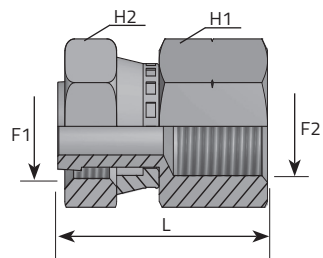

Code	Thread		Dimensions			Pressure	
	F1	F2	H1	H2	L	Bar	Psi
	in	mm	mm	mm	mm		
AFGO06FFM10	9/16	10x1	19	17	39	630	9136
AFGO09FFM10	11/16	10x1	19	22	41	630	9136
AFGO11FFM10	13/16	10x1	19	24	43	630	9136
AFGO13FFM10	1	10x1	24	30	40	420	6091
AFGO14FFM10	1.3/16	10x1	-	36	-	420	6091
AFGO15FFM10	1.7/16	10x1	-	41	-	420	6091
AFGO21FFM10	1.11/16	10x1	-	50	-	280	4060
AFGO32FFM10	2	10x1	-	60	-	280	4060

## ZŁĄCZKA ZEŃSKA ORFS - METRYCZNA MĘSKA

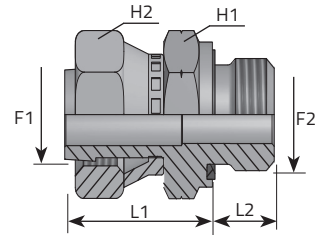

Code	Thread		Dimensions				Pressure	
	F1 in	F2 mm	H1 mm	H2 mm	L1 mm	L2 mm	Bar	Psi
AFGO06MM12R	9/16	12X1.5	17	17	26.5	12	630	9136
<b>AFGO09MM14R</b>	<b>11/16</b>	<b>14X1.5</b>	<b>19</b>	<b>22</b>	<b>28.5</b>	<b>12</b>	<b>630</b>	<b>9136</b>
AFGO11MM18R	13/16	18X1.5	24	24	35.5	12	630	9136
<b>AFGO13MM22R</b>	<b>1</b>	<b>22X1.5</b>	<b>27</b>	<b>30</b>	<b>38</b>	<b>14</b>	<b>420</b>	<b>6091</b>
AFGO14MM27R	1.3/16	27X2	32	36	41.5	16	420	6091
<b>AFGO15MM33R</b>	<b>1.7/16</b>	<b>33X2</b>	<b>41</b>	<b>41</b>	<b>49</b>	<b>18</b>	<b>420</b>	<b>6091</b>
AFGO21MM42R	1.11/16	42X2	50	50	49	20	280	4060
<b>AFGO32MM48R</b>	<b>2</b>	<b>48X2</b>	<b>55</b>	<b>60</b>	<b>49</b>	<b>22</b>	<b>280</b>	<b>4060</b>
AFGO06MM10R	9/16	10X1	17	17	26.5	8	350	5076
<b>AFGO09MM16R</b>	<b>11/16</b>	<b>16X1.5</b>	<b>22</b>	<b>22</b>	<b>28.5</b>	<b>12</b>	<b>630</b>	<b>9136</b>
AFGO11MM16R	13/16	16X1.5	22	24	34.5	12	630	9136
<b>AFGO13MM18R</b>	<b>1</b>	<b>18X1.5</b>	<b>27</b>	<b>30</b>	<b>38</b>	<b>12</b>	<b>420</b>	<b>6091</b>
AFGO14MM22R	1.3/16	22X1.5	32	36	41.5	14	420	6091
<b>AFGO15MM27R</b>	<b>1.7/16</b>	<b>27X2</b>	<b>41</b>	<b>41</b>	<b>49</b>	<b>16</b>	<b>420</b>	<b>6091</b>

## ZŁĄCZKA MĘSKA ORFS - MĘSKA UNF (1)

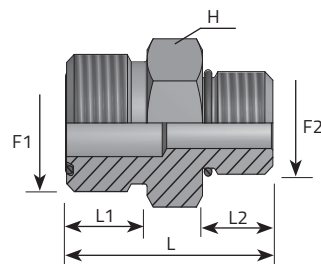

Code	Thread		Dimensions				Pressure	
	F1	F2	H	L1	L2	L	Bar	Psi
	in	in	mm	mm	mm	mm		
AM006MU04	9/16	7/16	17	10	11	29	630	9136
<b>AM009MU06</b>	<b>11/16</b>	<b>9/16</b>	<b>19</b>	<b>11</b>	<b>12</b>	<b>32</b>	<b>630</b>	<b>9136</b>
AM011MU08	13/16	3/4	22	13	14	36,5	630	9136
<b>AM013MU10</b>	<b>1</b>	<b>7/8</b>	<b>27</b>	<b>15.5</b>	<b>16</b>	<b>43</b>	<b>420</b>	<b>6091</b>
AM014MU12	1.3/16	1.1/16	32	17	18.5	48,5	420	6091
<b>AM015MU16</b>	<b>1.7/16</b>	<b>1.5/16</b>	<b>41</b>	<b>17.5</b>	<b>18.5</b>	<b>50,5</b>	<b>420</b>	<b>6091</b>
AM021MU20	1.11/16	1.5/8	46	17.5	18.5	52	280	4060
<b>AM032MU24</b>	<b>2</b>	<b>1.7/8</b>	<b>55</b>	<b>17.5</b>	<b>18.5</b>	<b>54</b>	<b>280</b>	<b>4060</b>
AM006MU05	9/16	1/2	17	10	11	29	630	9136
<b>AM006MU06</b>	<b>9/16</b>	<b>9/16</b>	<b>19</b>	<b>10</b>	<b>12</b>	<b>31</b>	<b>630</b>	<b>9136</b>
AM006MU08	9/16	3/4	22	10	14	33,5	630	9136
<b>AM009MU04</b>	<b>11/16</b>	<b>7/16</b>	<b>19</b>	<b>11</b>	<b>11</b>	<b>31</b>	<b>630</b>	<b>9136</b>
AM009MU05	11/16	1/2	19	11	11	31	630	9136
<b>AM009MU08</b>	<b>11/16</b>	<b>3/4</b>	<b>22</b>	<b>11</b>	<b>14</b>	<b>34,5</b>	<b>630</b>	<b>9136</b>
AM009MU10	11/16	7/8	27	11	16	38,5	630	9136
<b>AM009MU12</b>	<b>11/16</b>	<b>1.1/16</b>	<b>32</b>	<b>11</b>	<b>18.5</b>	<b>42,5</b>	<b>420</b>	<b>6091</b>

## ZŁĄCZKA MĘSKA ORFS - MĘSKA UNF (2)

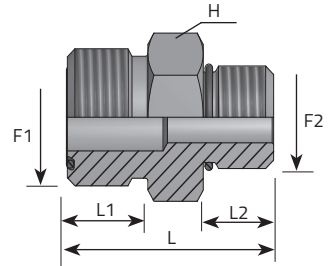

Code	Thread		Dimensions				Pressure	
	F1	F2	H	L1	L2	L	Bar	Psi
	in	in	mm	mm	mm	mm		
AMO11MU06	13/16	9/16	22	13	12	34,5	630	9136
<b>AMO11MU10</b>	<b>13/16</b>	<b>7/8</b>	<b>27</b>	<b>13</b>	<b>16</b>	<b>40,5</b>	<b>630</b>	<b>9136</b>
AMO11MU12	13/16	1.1/16	32	13	18.5	44,5	420	6091
<b>AMO11MU16</b>	<b>13/16</b>	<b>1.5/16</b>	<b>41</b>	<b>13</b>	<b>18.5</b>	<b>46</b>	<b>420</b>	<b>6091</b>
AMO13MU08	1	3/4	27	15.5	14	41	420	6091
<b>AMO13MU12</b>	<b>1</b>	<b>1.1/16</b>	<b>32</b>	<b>15.5</b>	<b>18.5</b>	<b>47</b>	<b>420</b>	<b>6091</b>
AMO14MU08	1.3/16	3/4	32	17	14	44	420	6091
<b>AMO14MU10</b>	<b>1.3/16</b>	<b>7/8</b>	<b>32</b>	<b>17</b>	<b>16</b>	<b>46</b>	<b>420</b>	<b>6091</b>
AMO14MU16	1.3/16	1.5/16	41	17	18.5	50	420	6091
<b>AMO15MU12</b>	<b>1.7/16</b>	<b>1.1/16</b>	<b>41</b>	<b>17.5</b>	<b>18.5</b>	<b>50,5</b>	<b>420</b>	<b>6091</b>
AMO15MU20	1.7/16	1.5/8	46	17.5	15	48.5	280	4060
<b>AMO21MU16</b>	<b>1.11/16</b>	<b>1.5/16</b>	<b>46</b>	<b>17.5</b>	<b>18.5</b>	<b>52</b>	<b>280</b>	<b>4060</b>
AMO21MU24	1.11/16	1.7/8	55	17.5	18.5	54	280	4060
<b>AMO32MU20</b>	<b>2</b>	<b>1.5/8</b>	<b>55</b>	<b>17.5</b>	<b>15</b>	<b>50.5</b>	<b>280</b>	<b>4060</b>

## ZŁĄCZKA ZEŃSKA ORFS - MĘSKA UNF

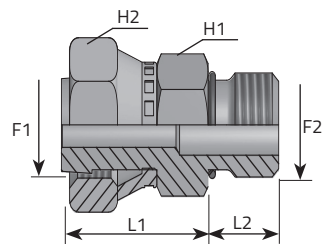

Code	Thread		Dimensions				Pressure	
	F1	F2	H1	H2	L1	L2	Bar	Psi
	in	in	mm	mm	mm	mm		
AFGO06MU04	9/16	7/16	17	17	26.5	11	630	9136
<b>AFGO09MU06</b>	<b>11/16</b>	<b>9/16</b>	<b>19</b>	<b>22</b>	<b>28.5</b>	<b>12</b>	<b>630</b>	<b>9136</b>
AFGO11MU08	13/16	3/4	22	24	35.5	14	630	9136
<b>AFGO13MU10</b>	<b>1</b>	<b>7/8</b>	<b>27</b>	<b>30</b>	<b>38</b>	<b>16</b>	<b>420</b>	<b>6091</b>
AFGO14MU12	1.3/16	1.1/16	32	36	41.5	18.5	420	6091
<b>AFGO15MU16</b>	<b>1.7/16</b>	<b>1.5/16</b>	<b>41</b>	<b>41</b>	<b>49</b>	<b>18.5</b>	<b>420</b>	<b>6091</b>
AFGO21MU20	1.11/16	1.5/8	46	50	49	18.5	280	4060
<b>AFGO32MU24</b>	<b>2</b>	<b>1.7/8</b>	<b>55</b>	<b>60</b>	<b>49</b>	<b>18.5</b>	<b>280</b>	<b>4060</b>
AFGO09MU04	11/16	7/16	19	22	28.5	11	630	9136
<b>AFGO09MU08</b>	<b>11/16</b>	<b>3/4</b>	<b>22</b>	<b>22</b>	<b>32.5</b>	<b>11</b>	<b>630</b>	<b>9136</b>
AFGO11MU10	13/16	7/8	27	24	34	16	630	9136
<b>AFGO13MU08</b>	<b>1</b>	<b>3/4</b>	<b>27</b>	<b>30</b>	<b>38</b>	<b>14</b>	<b>420</b>	<b>6091</b>
AFGO13MU12	1	1.1/16	32	30	39	18.5	420	6091
<b>AFGO14MU10</b>	<b>1.3/16</b>	<b>7/8</b>	<b>32</b>	<b>36</b>	<b>41.5</b>	<b>16</b>	<b>420</b>	<b>6091</b>
AFGO14MU16	1.3/16	1.5/16	41	36	48	18.5	420	6091

## ZŁĄCZKA MĘSKA ORFS - MĘSKA NPT

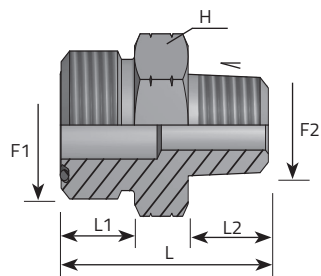

Code	Thread		Dimensions				Pressure	
	F1	F2	H	L1	L2	L	Bar	Psi
	in	in	mm	mm	mm	mm		
AMO06MN02	9/16	1/8	17	10	10	27,5	420	6091
<b>AMO09MN04</b>	<b>11/16</b>	<b>1/4</b>	<b>19</b>	<b>11</b>	<b>14,5</b>	<b>34,5</b>	<b>630</b>	<b>9136</b>
AMO11MN06	13/16	3/8	22	13	14,5	37	630	9136
<b>AMO13MN08</b>	<b>1</b>	<b>1/2</b>	<b>27</b>	<b>15,5</b>	<b>19</b>	<b>46</b>	<b>420</b>	<b>6091</b>
AMO14MN12	1.3/16	3/4	32	17	19	49	420	6091
<b>AMO15MN16</b>	<b>1.7/16</b>	<b>1</b>	<b>41</b>	<b>17,5</b>	<b>24</b>	<b>56</b>	<b>420</b>	<b>6091</b>
AMO21MN20	1.11/16	1.1/4	46	17,5	25	59	280	4060
<b>AMO32MN24</b>	<b>2</b>	<b>1.1/2</b>	<b>55</b>	<b>17,5</b>	<b>26</b>	<b>61,5</b>	<b>280</b>	<b>4060</b>
AMO06MN04	9/16	1/4	17	10	14,5	32	630	9136
<b>AMO06MN06</b>	<b>9/16</b>	<b>3/8</b>	<b>17</b>	<b>10</b>	<b>14,5</b>	<b>32</b>	<b>630</b>	<b>9136</b>
AMO09MN06	11/16	3/8	19	11	14,5	34,5	630	9136
<b>AMO09MN08</b>	<b>11/16</b>	<b>1/2</b>	<b>22</b>	<b>11</b>	<b>19</b>	<b>39,5</b>	<b>630</b>	<b>9136</b>
AMO11MN04	13/16	1/4	22	13	14,5	37	630	9136
<b>AMO11MN08</b>	<b>13/16</b>	<b>1/2</b>	<b>22</b>	<b>13</b>	<b>19</b>	<b>41,5</b>	<b>630</b>	<b>9136</b>
AMO11MN12	13/16	3/4	27	13	19	43,5	420	6091
<b>AMO13MN06</b>	<b>1</b>	<b>3/8</b>	<b>27</b>	<b>15,5</b>	<b>14,5</b>	<b>41,5</b>	<b>420</b>	<b>6091</b>
AMO13MN12	1	3/4	27	15,5	19	46	420	6091
<b>AMO14MN08</b>	<b>1.3/16</b>	<b>1/2</b>	<b>32</b>	<b>17</b>	<b>19</b>	<b>49</b>	<b>420</b>	<b>6091</b>
AMO14MN16	1.3/16	1	36	17	24	54	420	6091
<b>AMO15MN12</b>	<b>1.7/16</b>	<b>3/4</b>	<b>41</b>	<b>17,5</b>	<b>19</b>	<b>51</b>	<b>420</b>	<b>6091</b>
AMO21MN16	1.11/16	1	46	17,5	24	58	280	4060
<b>AMO32MN20</b>	<b>2</b>	<b>1.1/4</b>	<b>55</b>	<b>17,5</b>	<b>25</b>	<b>60,5</b>	<b>280</b>	<b>4060</b>



## 90° ZŁĄCZKA MĘSKA ORFS - MĘSKA NPT

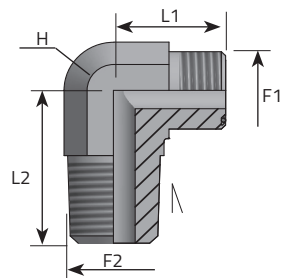

Code	Thread		Dimensions			Pressure	
	F1	F2	H	L1	L2	Bar	Psi
	in	in	mm	mm	mm		
LMO06MN02	9/16	1/8	14	21.5	20	420	6091
<b>LMO09MN04</b>	<b>11/16</b>	<b>1/4</b>	<b>19</b>	<b>25</b>	<b>31</b>	<b>630</b>	<b>9136</b>
LMO11MN06	13/16	3/8	22	28	31	630	9136
<b>LMO13MN08</b>	<b>1</b>	<b>1/2</b>	<b>27</b>	<b>33.5</b>	<b>37.5</b>	<b>420</b>	<b>6091</b>
LMO14MN12	1.3/16	3/4	30	37.5	40	420	6091
<b>LMO15MN16</b>	<b>1.7/16</b>	<b>1</b>	<b>36</b>	<b>41.5</b>	<b>50</b>	<b>420</b>	<b>6091</b>
LMO21MN20	1.11/16	1.1/4	41	52	60	280	4060
<b>LMO32MN24</b>	<b>2</b>	<b>1.1/2</b>	<b>48</b>	<b>49</b>	<b>67</b>	<b>280</b>	<b>4060</b>
LMO06MN04	9/16	1/4	14	21.5	28	630	9136
<b>LMO06MN06</b>	<b>9/16</b>	<b>3/8</b>	<b>19</b>	<b>23.5</b>	<b>31</b>	<b>630</b>	<b>9136</b>
LMO09MN06	11/16	3/8	19	25	31	630	9136
<b>LMO09MN08</b>	<b>11/16</b>	<b>1/2</b>	<b>22</b>	<b>28</b>	<b>37.5</b>	<b>630</b>	<b>9136</b>
LMO11MN04	13/16	1/4	22	28	31	630	9136
<b>LMO11MN08</b>	<b>13/16</b>	<b>1/2</b>	<b>22</b>	<b>30</b>	<b>37.5</b>	<b>630</b>	<b>9136</b>
LMO11MN12	13/16	3/4	27	31.5	40	420	6091
<b>LMO13MN06</b>	<b>1</b>	<b>3/8</b>	<b>27</b>	<b>33.5</b>	<b>33</b>	<b>420</b>	<b>6091</b>
LMO13MN12	1	3/4	27	33.5	40	420	6091
<b>LMO14MN08</b>	<b>1.3/16</b>	<b>1/2</b>	<b>30</b>	<b>37.5</b>	<b>40</b>	<b>420</b>	<b>6091</b>
LMO14MN16	1.3/16	1	33	38	50	420	6091
<b>LMO15MN12</b>	<b>1.7/16</b>	<b>3/4</b>	<b>36</b>	<b>41.5</b>	<b>45.5</b>	<b>420</b>	<b>6091</b>
LMO21MN16	1.11/16	1	41	52	59	280	4060
<b>LMO32MN20</b>	<b>2</b>	<b>1.1/4</b>	<b>48</b>	<b>49</b>	<b>66</b>	<b>280</b>	<b>4060</b>

## 45° ZŁĄCZKA MĘSKA ORFS - MĘSKA NPT

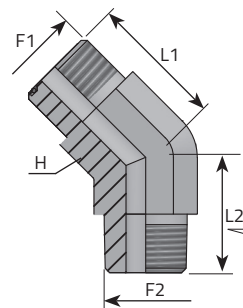

Code	Thread		Dimensions			Pressure	
	F1 in	F2 in	H mm	L1 mm	L2 mm	Bar	Psi
QMO06MN02	9/16	1/8	14	16	16.5	420	6091
<b>QMO09MN04</b>	<b>11/16</b>	<b>1/4</b>	<b>19</b>	<b>19</b>	<b>24</b>	<b>630</b>	<b>9136</b>
QMO11MN06	13/16	3/8	22	20.5	24	630	9136
<b>QMO13MN08</b>	<b>1</b>	<b>1/2</b>	<b>27</b>	<b>23.5</b>	<b>30.5</b>	<b>420</b>	<b>6091</b>
QMO14MN12	1.3/16	3/4	30	26	30.5	420	6091
<b>QMO15MN16</b>	<b>1.7/16</b>	<b>1</b>	<b>36</b>	<b>30</b>	<b>38</b>	<b>420</b>	<b>6091</b>
QMO21MN20	1.11/16	1.1/4	41	32	42	280	4060
<b>QMO32MN24</b>	<b>2</b>	<b>1.1/2</b>	<b>48</b>	<b>37</b>	<b>45</b>	<b>280</b>	<b>4060</b>
QMO06MN04	9/16	1/4	14	16	22	630	9136
<b>QMO06MN06</b>	<b>9/16</b>	<b>3/8</b>	<b>19</b>	<b>17.5</b>	<b>24</b>	<b>630</b>	<b>9136</b>
QMO09MN06	11/16	3/8	19	19	24	630	9136
<b>QMO09MN08</b>	<b>11/16</b>	<b>1/2</b>	<b>22</b>	<b>20</b>	<b>29.5</b>	<b>630</b>	<b>9136</b>
QMO11MN04	13/16	1/4	22	20.5	24	630	9136
<b>QMO11MN08</b>	<b>13/16</b>	<b>1/2</b>	<b>22</b>	<b>21</b>	<b>29.5</b>	<b>630</b>	<b>9136</b>
QMO11MN12	13/16	3/4	27	21.5	30.5	420	6091
<b>QMO13MN06</b>	<b>1</b>	<b>3/8</b>	<b>27</b>	<b>23.5</b>	<b>27</b>	<b>420</b>	<b>6091</b>
QMO13MN12	1	3/4	27	23.5	30.5	420	6091
<b>QMO14MN08</b>	<b>1.3/16</b>	<b>1/2</b>	<b>30</b>	<b>26</b>	<b>30.5</b>	<b>420</b>	<b>6091</b>
QMO14MN16	1.3/16	1	33	29.5	38	420	6091
<b>QMO15MN12</b>	<b>1.7/16</b>	<b>3/4</b>	<b>36</b>	<b>30</b>	<b>33</b>	<b>420</b>	<b>6091</b>
QMO21MN16	1.11/16	1	41	32	41	280	4060
<b>QMO32MN20</b>	<b>2</b>	<b>1.1/4</b>	<b>48</b>	<b>37</b>	<b>44</b>	<b>280</b>	<b>4060</b>

## ZŁĄCZKA MĘSKA ORFS - STAŁA ZEŃSKA NPT

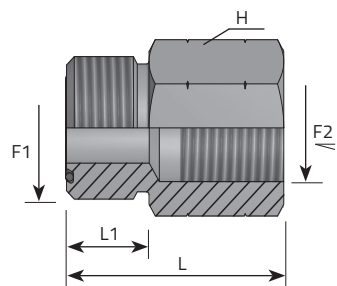

Code	Thread		Dimensions			Pressure	
	F1 in	F2 in	H mm	L1 mm	L mm	Bar	Psi
AMO06FFN04	9/16	1/4	19	10	31,5	630	9136
AMO09FFN04	11/16	1/4	19	11	32,5	630	9136
AMO11FFN06	13/16	3/8	24	13	36	630	9136
AMO13FFN08	1	1/2	30	15.5	44	420	6091
AMO14FFN12	1.3/16	3/4	36	17	47	420	6091
AMO15FFN16	1.7/16	1	41	17.5	54	420	6091
AMO21FFN20	1.11/16	1.1/4	55	17.5	56,5	280	4060
AMO32FFN24	2	1.1/2	60	17.5	56,5	280	4060
AMO11FFN04	13/16	1/4	22	13	34,5	630	9136
AMO14FFN08	1.3/16	1/2	32	17	45,5	420	6091

## PROSTA GRODZIOWA ZŁĄCZKA MĘSKA ORFS - ZEŃSKA NPT

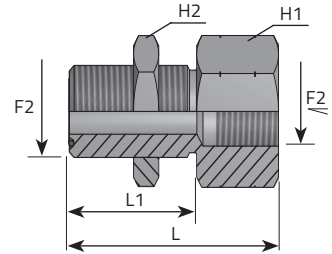

Code	Thread		Dimensions				Pressure	
	F1	F2	H	H1	L1	L	Bar	Psi
	in	in	mm	mm	mm	mm		
APPM006FFN04	9/16	1/4	22	22	31.5	53	630	9136
APPM009FFN04	11/16	1/4	27	27	34	55.5	630	9136
APPM011FFN06	13/16	3/8	30	30	36.5	59	630	9136
APPM013FFN08	1	1/2	36	36	40.5	69	420	6091
APPM014FFN12	1.3/16	3/4	41	41	41.5	71.5	420	6091
APPM015FFN16	1.7/16	1	46	46	42	78.5	420	6091
APPM021FFN20	1.11/16	1.1/4	50	50	42	81	280	4060
APPM032FFN24	2	1.1/2	60	60	42	81	280	4060

## ZŁĄCZKA MĘSKA ORFS - MĘSKA DIN

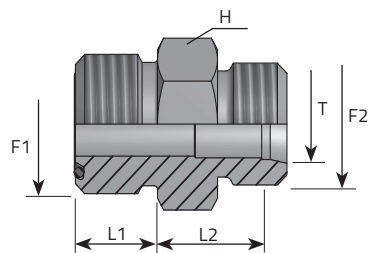

Code	Thread		Dimensions				Pressure	
	F1	F2	H	L1	L2	T	Bar	Psi
	in	in	mm	mm	mm	mm		
AMO06ME06L.1	9/16	12X1.5	17	10	10.5	6	315	4568
<b>AMO06ME08L.1</b>	<b>9/16</b>	<b>14X1.5</b>	<b>17</b>	<b>10</b>	<b>10.5</b>	<b>8</b>	<b>315</b>	<b>4568</b>
AMO09ME10L.1	11/16	16X1.5	19	11	13	10	315	4568
<b>AMO11ME12L.1</b>	<b>13/16</b>	<b>18X1.5</b>	<b>22</b>	<b>13</b>	<b>13.5</b>	<b>12</b>	<b>315</b>	<b>4568</b>
AMO13ME15L.1	1	22X1.5	27	15.5	16.5	15	315	4568
<b>AMO14ME18L.1</b>	<b>1.3/16</b>	<b>26X1.5</b>	<b>32</b>	<b>17</b>	<b>17.5</b>	<b>18</b>	<b>315</b>	<b>4568</b>
AMO15ME22L.1	1.7/16	30X2	41	17.5	21	22	160	2320
<b>AMO21ME28L.1</b>	<b>1.11/16</b>	<b>36X2</b>	<b>46</b>	<b>17.5</b>	<b>23</b>	<b>28</b>	<b>160</b>	<b>2320</b>
AMO32ME35L.1	2	45X2	55	17.5	23.5	35	160	2320
<b>AMO32ME42L.1</b>	<b>2</b>	<b>52X2</b>	<b>55</b>	<b>17.5</b>	<b>23</b>	<b>42</b>	<b>160</b>	<b>2320</b>
AMO06ME06S.1	9/16	14X1.5	17	10	12.5	6	630	9136
<b>AMO06ME08S.1</b>	<b>9/16</b>	<b>16X1.5</b>	<b>17</b>	<b>10</b>	<b>12.5</b>	<b>8</b>	<b>630</b>	<b>9136</b>
AMO09ME10S.1	11/16	18X1.5	19	11	13.5	10	630	9136
<b>AMO11ME12S.1</b>	<b>13/16</b>	<b>20X1.5</b>	<b>22</b>	<b>13</b>	<b>14</b>	<b>12</b>	<b>630</b>	<b>9136</b>
AMO13ME14S.1	1	22X1.5	27	15.5	19.5	14	420	6091
<b>AMO13ME16S.1</b>	<b>1</b>	<b>24X1.5</b>	<b>27</b>	<b>15.5</b>	<b>20</b>	<b>16</b>	<b>400</b>	<b>5801</b>
AMO14ME20S.1	1.3/16	30X2	32	17	18.5	20	400	5801
<b>AMO15ME25S.1</b>	<b>1.7/16</b>	<b>36X2</b>	<b>41</b>	<b>17.5</b>	<b>20.5</b>	<b>25</b>	<b>400</b>	<b>5801</b>
AMO21ME30S.1	1.11/16	42X2	46	17.5	23	30	280	4060
<b>AMO32ME38S.1</b>	<b>2</b>	<b>52X2</b>	<b>55</b>	<b>17.5</b>	<b>24</b>	<b>38</b>	<b>280</b>	<b>4060</b>

## ZŁĄCZKA MĘSKA ORFS - ZEŃSKA DIN (DRUTOWANA)

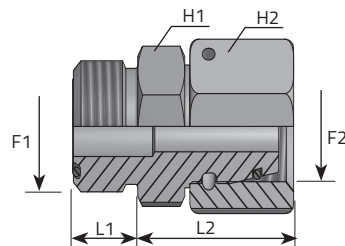

Code	Thread		Dimensions					Pressure	
	F1	F2	H1	H2	L1	L2	T	Bar	Psi
	in	mm	mm	mm	mm	mm	mm		
AMO06FE06L	9/16	12X1.5	17	14	10	24.5	6	315	4568
<b>AMO06FE08L</b>	<b>9/16</b>	<b>14X1.5</b>	<b>17</b>	<b>17</b>	<b>10</b>	<b>24.5</b>	<b>8</b>	<b>315</b>	<b>4568</b>
AMO09FE10L	11/16	16X1.5	19	19	11	26.5	10	315	4568
AMO11FE12L	<b>13/16</b>	<b>18X1.5</b>	<b>22</b>	<b>22</b>	<b>13</b>	<b>27</b>	<b>12</b>	<b>315</b>	<b>4568</b>
AMO13FE15L	1	22X1.5	27	27	15.5	31	15	315	4568
AMO14FE18L	<b>1.3/16</b>	<b>26X1.5</b>	<b>32</b>	<b>32</b>	<b>17</b>	<b>33.5</b>	<b>18</b>	<b>315</b>	<b>4568</b>
AMO15FE22L	1.7/16	30X2	41	36	17.5	36	22	160	2320
AMO21FE28L	<b>1.11/16</b>	<b>36X2</b>	<b>46</b>	<b>41</b>	<b>17.5</b>	<b>39</b>	<b>28</b>	<b>160</b>	<b>2320</b>
AMO32FE35L	2	45X2	55	50	17.5	45	35	160	2320
AMO32FE42L	2	52X2	55	60	17.5	45	42	160	2320
AMO06FE06S	9/16	14X1.5	17	17	10	24.5	6	630	9136
AMO06FE08S	9/16	16X1.5	17	19	10	25	8	630	9136
AMO09FE10S	11/16	18X1.5	19	22	11	27	10	630	9136
AMO11FE12S	<b>13/16</b>	<b>20X1.5</b>	<b>22</b>	<b>24</b>	<b>13</b>	<b>27.5</b>	<b>12</b>	<b>630</b>	<b>9136</b>
AMO13FE14S	1	22X1.5	27	27	15.5	32.5	14	420	6091
AMO13FE16S	1	24X1.5	27	30	15.5	35	16	400	5801
AMO14FE20S	1.3/16	30X2	32	36	17	39	20	400	5801
AMO15FE25S	1.7/16	36X2	41	46	17.5	43	25	400	5801
AMO21FE30S	1.11/16	42X2	46	50	17.5	47.5	30	280	4060
AMO32FE38S	2	52X2	55	60	17.5	51	38	280	4060

## ZŁĄCZKA MĘSKA ORFS - MĘSKA JIC

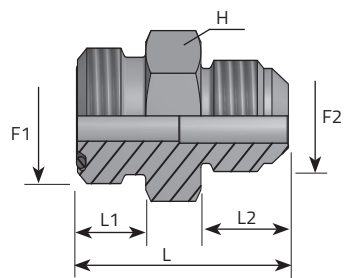

Code	Thread		Dimensions				Pressure	
	F1 in	F2 in	H mm	L1 mm	L2 mm	L mm	Bar	Psi
AMO06MJ04	9/16	7/16	17	10	14	31.5	450	6526
<b>AMO09MJ06</b>	<b>11/16</b>	<b>9/16</b>	<b>19</b>	<b>11</b>	<b>14.1</b>	<b>34</b>	<b>350</b>	<b>5076</b>
AMO11MJ08	13/16	3/4	22	13	16.7	39	350	5076
<b>AMO13MJ10</b>	<b>1</b>	<b>7/8</b>	<b>27</b>	<b>15.5</b>	<b>19.3</b>	<b>46.5</b>	<b>350</b>	<b>5076</b>
AMO14MJ12	1.3/16	1.1/16	32	17	21.9	52	350	5076
<b>AMO15MJ16</b>	<b>1.7/16</b>	<b>1.5/16</b>	<b>41</b>	<b>17.5</b>	<b>23.1</b>	<b>55</b>	<b>290</b>	<b>4205</b>
AMO21MJ20	1.11/16	1.5/8	46	17.5	24.3	58.5	240	3480
<b>AMO32MJ24</b>	<b>2</b>	<b>1.7/8</b>	<b>55</b>	<b>17.5</b>	<b>27.5</b>	<b>63</b>	<b>240</b>	<b>3480</b>
AMO09MJ05	11/16	1/2	19	11	14	34	450	6526

## ZŁĄCZKA MĘSKA ORFS - ZEŃSKA JIC

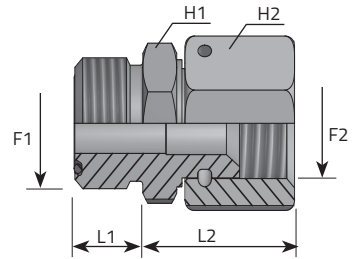

Code	Thread		Dimensions				Pressure		
	F1 in	F2 in	H1 mm	H2 mm	L1 mm	L2 mm	form	Bar	Psi
AMO06FGJ04	9/16	7/16	17	17	10	25	X	450	6526
AMO09FGJ06	11/16	9/16	19	19	11	29	X	350	5076
AMO11FGJ08	13/16	3/4	22	22	13	31.5	X	350	5076
AMO13FGJ10	1	7/8	27	27	15.5	37.5	X	350	5076
AMO14FGJ12	1.3/16	1.1/16	32	32	17	39	Y	350	5076
AMO15FGJ16	1.7/16	1.5/16	41	41	17.5	44.5	Y	290	4205
AMO21FGJ20	1.11/16	1.5/8	46	50	17.5	45.5	Y	240	3480
AMO32FGJ24	2	1.7/8	55	60	17.5	55.5	Y	240	3480
AMO09FGJ05	11/16	1/2	19	17	11	28	Y	450	6526

### Y: Version with crimped nut

Wersja z nakrętką zaciskaną

### X: Version with thrust-wire nut

Wersja z nakrętką drutowaną



## ZŁĄCZKA ZEŃSKA ORFS - MĘSKA JIC

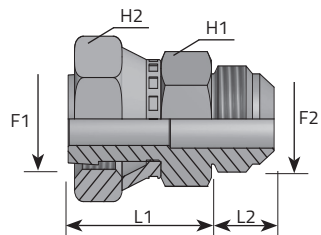

Code	Thread		Dimensions				Pressure	
	F1	F2	H1	H2	L1	L2	Bar	Psi
	in	in	mm	mm	mm	mm		
AFGO06MJ04	9/16	7/16	17	17	23.5	14	450	6526
<b>AFGO09MJ06</b>	<b>11/16</b>	<b>9/16</b>	<b>22</b>	<b>22</b>	<b>26.9</b>	<b>14.1</b>	<b>350</b>	<b>5076</b>
AFGO11MJ08	13/16	3/4	24	24	30.3	16.7	350	5076
<b>AFGO13MJ10</b>	<b>1</b>	<b>7/8</b>	<b>30</b>	<b>30</b>	<b>36.7</b>	<b>19.3</b>	<b>350</b>	<b>5076</b>
AFGO14MJ12	1.3/16	1.1/16	36	36	40.6	21.9	350	5076
<b>AFGO15MJ16</b>	<b>1.7/16</b>	<b>1.5/16</b>	<b>41</b>	<b>41</b>	<b>42.9</b>	<b>23.1</b>	<b>290</b>	<b>4205</b>
AFGO21MJ20	1.11/16	1.5/8	50	50	44.7	24.3	240	3480
<b>AFGO32MJ24</b>	<b>2</b>	<b>1.7/8</b>	<b>60</b>	<b>60</b>	<b>46.5</b>	<b>27.5</b>	<b>240</b>	<b>3480</b>
AFGO09MJ05	11/16	1/2	22	22	27	14	450	6526

## DO SPAWANIA ZŁĄCZKA MĘSKA ORFS (1)

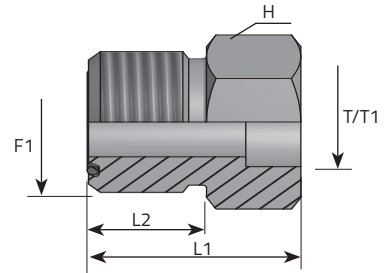

N.b.: No zinc-plated Parts

Code	Thread	Dimensions					Pressure	
		F1	H	L1	L2	T	T1	Bar
	in	mm	mm	mm	mm	in		
AMNSO06T6	9/16	17	22	10	6	1/4	630	9136
AMNSO09T10	11/16	19	23	11	10	3/8	630	9136
AMNSO11T12	13/16	22	24.5	13	12	1/2	630	9136
AMNSO13T16	1	27	28	15.5	16	5/8	420	6091
AMNSO14T20	1.3/16	32	33.5	17	20	3/4	420	6091
AMNSO15T25	1.7/16	41	38.5	17.5	25	1	420	6091
AMNSO21T30	1.11/16	46	38.5	17.5	30	1.1/4	280	4060
AMNSO32T38	2	55	38.5	17.5	38	1.1/2	280	4060
AMNSO06T8	9/16	17	22	10	8	5/16	630	9136
AMNSO06T10	9/16	17	22	10	10	3/8	630	9136
AMNSO06T12	9/16	19	22	10	12	1/2	630	9136
AMNSO09T6	11/16	19	23	11	6	1/4	630	9136
AMNSO09T8	11/16	19	23	11	8	5/16	630	9136
AMNSO09T12	11/16	19	23	11	12	1/2	630	9136
AMNSO09T14	11/16	22	23.5	11	14	-	420	6091
AMNSO09T15	11/16	22	23.5	11	15	-	420	6091
AMNSO09T16	11/16	22	23.5	11	16	5/8	420	6091
AMNSO11T6	13/16	22	24.5	13	6	1/4	630	9136
AMNSO11T8	13/16	22	24.5	13	8	5/16	630	9136
AMNSO11T10	13/16	22	24.5	13	10	3/8	630	9136
AMNSO11T14	13/16	22	25	13	14	-	420	6091
AMNSO11T15	13/16	22	25	13	15	-	420	6091

## DO SPAWANIA ZŁĄCZKA MĘSKA ORFS (2)

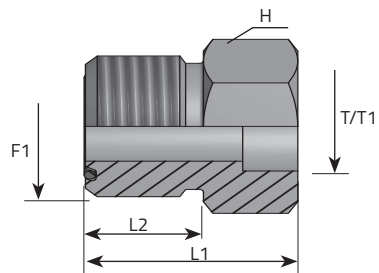

N.b.: No zinc-plated Parts  
Bez cynchanja

Code	Thread	Dimensions					Pressure	
		F1	H	L1	L2	T	T1	Bar
	in	mm	mm	mm	mm	in		
AMNSO11T16	13/16	22	25	13	16	5/8	420	6091
AMNSO11T18	13/16	27	28.5	13	18	-	420	6091
AMNSO11T20	13/16	27	28.5	13	20	3/4	420	6091
AMNSO11T22	13/16	32	28.5	13	22	7/8	420	6091
AMNSO11T25	13/16	32	30	13	25	1	420	6091
AMNSO13T10	1	27	27.5	15.5	10	3/8	420	6091
AMNSO13T12	1	27	27.5	15.5	12	1/2	420	6091
AMNSO13T14	1	27	28	15.5	14	-	420	6091
AMNSO13T15	1	27	28	15.5	15	-	420	6091
AMNSO13T18	1	27	31.5	15.5	18	-	420	6091
AMNSO13T20	1	27	31.5	15.5	20	3/4	420	6091
AMNSO14T12	1.3/16	32	29.5	17	12	1/2	420	6091
AMNSO14T14	1.3/16	32	30	17	14	-	420	6091
AMNSO14T15	1.3/16	32	30	17	15	-	420	6091
AMNSO14T16	1.3/16	32	30	17	16	5/8	420	6091
AMNSO14T18	1.3/16	32	33.5	17	18	-	420	6091
AMNSO14T22	1.3/16	32	33.5	17	22	7/8	420	6091
AMNSO14T25	1.3/16	32	35	17	25	1	420	6091
AMNSO15T12	1.7/16	41	33	17.5	12	1/2	420	6091
AMNSO15T14	1.7/16	41	33.5	17.5	14	-	420	6091
AMNSO15T15	1.7/16	41	33.5	17.5	15	-	420	6091
AMNSO15T16	1.7/16	41	33.5	17.5	16	5/8	420	6091

## DO SPAWANIA ZŁĄCZKA MĘSKA ORFS (3)

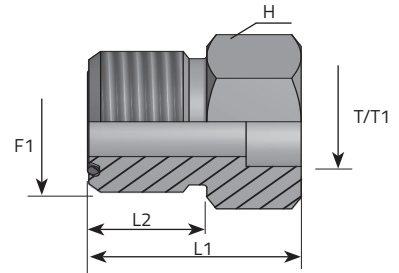

N.b.: No zinc-plated Parts

Code	Thread	Dimensions					Pressure		
		F1 in	H mm	L1 mm	L2 mm	T mm	T in	Bar	Psi
AMNSO15T18	1.7/16		41	37	17.5	18	-	420	6091
AMNSO15T20	1.7/16		41	37	17.5	20	3/4	420	6091
AMNSO15T22	1.7/16		41	37	17.5	22	7/8	420	6091
AMNSO15T28	1.7/16		41	38.5	17.5	28	-	280	4060
AMNSO15T30	1.7/16		41	38.5	17.5	30	1.1/4	280	4060
AMNSO15T32	1.7/16		41	38.5	17.5	32	-	280	4060
AMNSO21T18	1.11/16		46	37	17.5	18	-	280	4060
AMNSO21T20	1.11/16		46	37	17.5	20	3/4	280	4060
AMNSO21T22	1.11/16		46	37	17.5	22	7/8	280	4060
AMNSO21T25	1.11/16		46	38.5	17.5	25	1	280	4060
AMNSO21T28	1.11/16		46	38.5	17.5	28	-	280	4060
AMNSO21T32	1.11/16		46	38.5	17.5	32	-	280	4060
AMNSO21T35	1.11/16		50	38.5	17.5	35	-	280	4060
AMNSO21T38	1.11/16		50	38.5	17.5	38	1.1/2	280	4060
AMNSO32T25	2		55	38.5	17.5	25	1	280	4060
AMNSO32T28	2		55	38.5	17.5	28	-	280	4060
AMNSO32T30	2		55	38.5	17.5	30	1.1/4	280	4060
AMNSO32T32	2		55	38.5	17.5	32	-	280	4060
AMNSO32T35	2		55	38.5	17.5	35	-	280	4060

## DO SPAWANIA ZŁĄCZKA MĘSKA ORFS

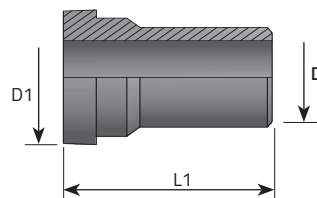

N.b.: No zinc-plated Parts

Code	Thread	Dimensions				Pressure	
		D1	L1	D	D	Bar	Psi
	in	mm	mm	in	mm		
T006W	1/4	12.75	25	1/4	6	630	9136
<b>T010W</b>	<b>5/16 - 3/8</b>	<b>15.75</b>	<b>26</b>	<b>3/8</b>	<b>10</b>	<b>630</b>	<b>9136</b>
T012W	1/2	18.9	26	1/2	12	630	9136
<b>T016W</b>	<b>5/8</b>	<b>23.45</b>	<b>32</b>	<b>5/8</b>	<b>16</b>	<b>420</b>	<b>6091</b>
T020W	3/4	17.85	37	3/4	20	420	6091
<b>T025W</b>	<b>7/8 - 1</b>	<b>34.2</b>	<b>42</b>	<b>1</b>	<b>25</b>	<b>420</b>	<b>6091</b>
T030W	1.1/4	40.55	44	1.1/4	30	280	4060
<b>T038W</b>	<b>1.1/2</b>	<b>48.5</b>	<b>49</b>	<b>1.1/2</b>	<b>38</b>	<b>280</b>	<b>4060</b>
T008W	5/16 - 3/8	15.75	25	5/16	8	630	9136
<b>T014W</b>	<b>5/8</b>	<b>23.45</b>	<b>32</b>	-	<b>14</b>	<b>420</b>	<b>6091</b>
T015W	5/8	23.45	32	-	15	420	6091
<b>T018W</b>	<b>3/4</b>	<b>17.85</b>	<b>37</b>	-	<b>18</b>	<b>420</b>	<b>6091</b>
T022W	7/8 - 1	34.2	37	7/8	22	420	6091
<b>T028W</b>	<b>1.1/4</b>	<b>40.55</b>	<b>44</b>	-	<b>28</b>	<b>280</b>	<b>4060</b>
T032W	1.1/4	40.55	44	-	32	280	4060
<b>T035W</b>	<b>1.1/2</b>	<b>48.5</b>	<b>44</b>	-	<b>35</b>	<b>280</b>	<b>4060</b>

## 90° ZŁĄCZKA MĘSKA ORFS

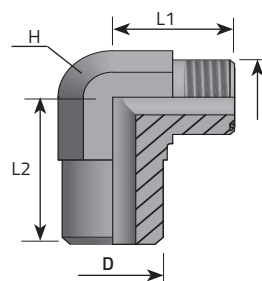

N.b.: No zinc-plated Parts

Code	Thread		Dimensions			Pressure	
	F1	D	H	L1	L2	Bar	Psi
	in	mm	mm	mm	mm		
LM006W6	9/16	6	14	21.5	20	630	9136
<b>LM009W10</b>	<b>11/16</b>	<b>10</b>	<b>19</b>	<b>25</b>	<b>25</b>	<b>630</b>	<b>9136</b>
LM011W12	13/16	12	22	28	25	630	9136
<b>LM013W16</b>	<b>1</b>	<b>16</b>	<b>27</b>	<b>33.5</b>	<b>33.5</b>	<b>420</b>	<b>6091</b>
LM014W20	1.3/16	20	30	37.5	37.5	420	6091
<b>LM015W25</b>	<b>1.7/16</b>	<b>25</b>	<b>36</b>	<b>41.5</b>	<b>42</b>	<b>420</b>	<b>6091</b>
LM021W30	1.11/16	30	41	44.5	45	280	4060
<b>LM032W38</b>	<b>2</b>	<b>38</b>	<b>48</b>	<b>49</b>	<b>61</b>	<b>280</b>	<b>4060</b>
LM009W8	11/16	8	19	25	25	630	9136
<b>LM013W14</b>	<b>1</b>	<b>14</b>	<b>27</b>	<b>33.5</b>	<b>33.5</b>	<b>420</b>	<b>6091</b>
LM013W15	1	15	27	33.5	33.5	420	6091
<b>LM014W18</b>	<b>1.3/16</b>	<b>18</b>	<b>30</b>	<b>37.5</b>	<b>37.5</b>	<b>420</b>	<b>6091</b>
LM015W22	1.7/16	22	36	41.5	42	420	6091
<b>LM021W28</b>	<b>1.11/16</b>	<b>28</b>	<b>41</b>	<b>44.5</b>	<b>45</b>	<b>280</b>	<b>4060</b>
LM021W32	1.11/16	32	41	44.5	45	280	4060
<b>LM032W35</b>	<b>2</b>	<b>35</b>	<b>48</b>	<b>49</b>	<b>61</b>	<b>280</b>	<b>4060</b>

## 90° ZŁĄCZKA ORFS ZEŃSKA DO SPAWANIA

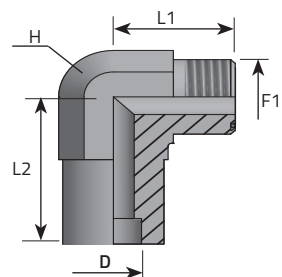

N.b.: No zinc-plated Parts

Code	Thread		Dimensions			Pressure	
	F1	D	H	L1	L2	Bar	Psi
	in	mm	mm	mm	mm		
LM006T6	9/16	6	14	21.5	20	630	9136
LM009T10	11/16	10	19	25	26	630	9136
LM011T12	13/16	12	22	30	27	630	9136
LM013T16	1	16	27	34	37	420	6091
LM014T20	1.3/16	20	30	37.5	32	420	6091
LM015T25	1.7/16	25	36	41.5	36.5	420	6091
LM021T30	1.11/16	30	41	52	48	280	4060
LM032T38	2	38	48	49	45	280	4060
LM009T8	11/16	8	19	25	25	630	9136
LM013T14	1	14	27	34	32	420	6091
LM013T15	1	15	27	34	32	420	6091
LM014T18	1.3/16	18	30	37.5	32	420	6091
LM015T22	1.7/16	22	36	41.5	37	420	6091
LM021T28	1.11/16	28	41	52	48	280	4060
LM021T32	1.11/16	32	41	52	48	280	4060
LM032T35	2	35	48	49.5	45	280	4060

## 90° NASTAWNA ZŁĄCZKA MĘSKA ORFS - MĘSKA BSPP Z O - RINGIEM (1)

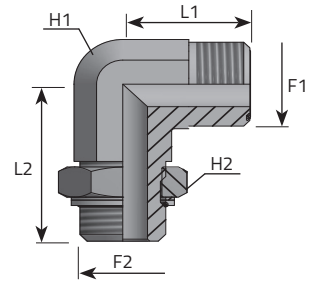

Code	Thread		Dimensions				Pressure	
	F1	F2	H1	H2	L1	L2	Bar	Psi
	in	in	mm	mm	mm	mm		
LMO06MOG02	9/16	1/8	14	14	21.5	30	350	5076
<b>LMO09MOG04</b>	<b>11/16</b>	<b>1/4</b>	<b>19</b>	<b>19</b>	<b>25</b>	<b>37</b>	<b>315</b>	<b>4568</b>
LMO11MOG06	13/16	3/8	22	22	28	38	250	3625
LMO13MOG08	1	1/2	27	27	33.5	48	250	3625
LMO14MOG12	1.3/16	3/4	30	36	37.5	51.5	250	3625
LMO15MOG16	1.7/16	1	36	41	41.5	58.5	200	2900
LMO21MOG20	1.11/16	1.1/4	41	50	52	60.5	200	2900
LMO32MOG24	2	1.1/2	48	55	49	64	160	2320
LMO06MOG04	9/16	1/4	14	19	21.5	35	315	4568
LMO06MOG06	9/16	3/8	19	22	23.5	38	250	3625
LMO09MOG06	11/16	3/8	19	22	25	38	250	3625
LMO09MOG08	11/16	1/2	22	27	28	48	250	3625
LMO11MOG04	13/16	1/4	22	19	28	37	315	4568
LMO11MOG08	13/16	1/2	22	27	30	48	250	3625
LMO11MOG12	13/16	3/4	27	36	31.5	51.5	250	3625
LMO13MOG04	1	1/4	27	19	33.5	42.5	315	4568
LMO13MOG06	1	3/8	27	22	33.5	42.5	250	3625
LMO13MOG12	1	3/4	27	36	33.5	51.5	250	3625



## 90° NASTAWNA ZŁĄCZKA MĘSKA ORFS - MĘSKA BSPP Z O - RINGIEM (2)

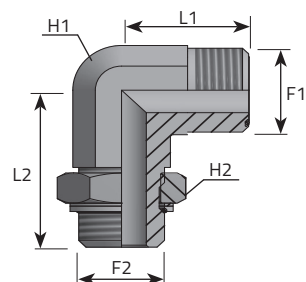

Code	Thread		Dimensions				Pressure	
	F1 in	F2 in	H1 mm	H2 mm	L1 mm	L2 mm	Bar	Psi
LMO13MOG16	1	1	33	41	37	58.5	200	2900
<b>LMO14MOG04</b>	<b>1.3/16</b>	<b>1/4</b>	<b>30</b>	<b>19</b>	<b>37.5</b>	<b>43.5</b>	<b>315</b>	<b>4568</b>
LMO14MOG08	1.3/16	1/2	30	27	37.5	49	250	3625
<b>LMO14MOG16</b>	<b>1.3/16</b>	<b>1</b>	<b>33</b>	<b>41</b>	<b>42</b>	<b>55</b>	<b>200</b>	<b>2900</b>
LMO15MOG04	1.7/16	1/4	36	19	41.5	52	315	4568
<b>LMO15MOG12</b>	<b>1.7/16</b>	<b>3/4</b>	<b>36</b>	<b>36</b>	<b>41.5</b>	<b>57.5</b>	<b>250</b>	<b>3625</b>
LMO15MOG20	1.7/16	1.1/4	41	50	50	60.5	200	2900
<b>LMO21MOG16</b>	<b>1.11/16</b>	<b>1</b>	<b>41</b>	<b>41</b>	<b>52</b>	<b>60.5</b>	<b>200</b>	<b>2900</b>
LMO21MOG24	1.11/16	1.1/2	48	55	43.5	67	160	2320

## 90° NASTAWNA ZŁĄCZKA MĘSKA ORFS - METRYCZNA MĘSKA Z O - RINGIEM

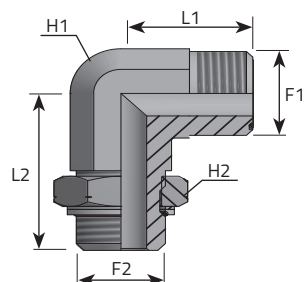

Code	Thread		Dimensions				Pressure	
	F1	F2	H1	H2	L1	L2	Bar	Psi
	in	mm	mm	mm	mm	mm		
LMO06MOM12R	9/16	12X1.5	14	17	21.5	33	315	4568
<b>LMO09MOM14R</b>	<b>11/16</b>	<b>14X1.5</b>	<b>19</b>	<b>19</b>	<b>25</b>	<b>35.5</b>	<b>315</b>	<b>4568</b>
LMO11MOM18R	13/16	18X1.5	22	24	28	41	315	4568
LMO13MOM22R	1	22X1.5	27	27	33.5	49	250	3625
LMO14MOM27R	1.3/16	27X2	30	32	37.5	55.5	250	3625
LMO15MOM33R	1.7/16	33X2	36	41	41.5	59.5	160	2320
LMO21MOM42R	1.11/16	42X2	41	50	52	63	160	2320
LMO32MOM48R	2	48X2	48	55	49	68.5	160	2320
LMO06MOM10R	9/16	10X1	14	14	21.5	30	315	4568
<b>LMO09MOM16R</b>	<b>11/16</b>	<b>16X1.5</b>	<b>19</b>	<b>22</b>	<b>25</b>	<b>37.5</b>	<b>315</b>	<b>4568</b>
LMO11MOM16R	13/16	16X1.5	22	22	28	37.5	315	4568
LMO11MOM22R	13/16	22X1.5	27	27	31.5	49	250	3625
LMO13MOM18R	1	18X1.5	27	24	33.5	47.5	315	4568
LMO13MOM27R	1	27X2	27	32	33.5	55.5	250	3625
LMO14MOM22R	1.3/16	22X1.5	30	27	37.5	49.5	250	3625
LMO14MOM33R	1.3/16	33X2	33	41	38	59.5	160	2320
LMO15MOM27R	1.7/16	27X2	36	32	41.5	59.5	250	3625
LMO15MOM42R	1.7/16	42X2	41	50	44.5	63	160	2320
LMO21MOM48R	1.11/16	48X2	48	55	52	68.5	160	2320

## 90° NASTAWNA ZŁĄCZKA MĘSKA ORFS - MĘSKA UNF Z O - RINGIEM (1)

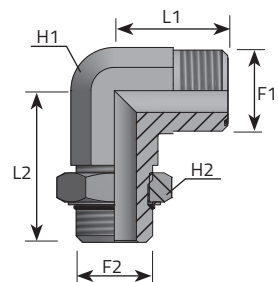

Code	Thread		Dimensions				Pressure	
	F1 in	F2 in	H1 mm	H2 mm	L1 mm	L2 mm	Bar	Psi
LMO06MOU04	9/16	7/16	14	14	21.5	32.5	420	6091
<b>LMO09MOU06</b>	<b>11/16</b>	<b>9/16</b>	<b>19</b>	<b>17</b>	<b>25</b>	<b>37</b>	<b>420</b>	<b>6091</b>
LMO11MOU08	13/16	3/4	22	22	28	40.5	420	6091
<b>LMO13MOU10</b>	<b>1</b>	<b>7/8</b>	<b>27</b>	<b>27</b>	<b>33.5</b>	<b>50</b>	<b>420</b>	<b>6091</b>
LMO14MOU12	1.3/16	1.1/16	30	32	37.5	55	420	6091
<b>LMO15MOU16</b>	<b>1.7/16</b>	<b>1.5/16</b>	<b>36</b>	<b>41</b>	<b>41.5</b>	<b>59.5</b>	<b>380</b>	<b>5511</b>
LMO21MOU20	1.11/16	1.5/8	41	50	52	62	280	4060
<b>LMO32MOU24</b>	<b>2</b>	<b>1.7/8</b>	<b>48</b>	<b>55</b>	<b>49</b>	<b>66</b>	<b>280</b>	<b>4060</b>
LMO06MOU06	9/16	9/16	14	17	21.5	34.5	420	6091
<b>LMO06MOU08</b>	<b>9/16</b>	<b>3/4</b>	<b>19</b>	<b>22</b>	<b>23.5</b>	<b>40.5</b>	<b>420</b>	<b>6091</b>
LMO09MOU04	11/16	7/16	19	14	25	35	420	6091
<b>LMO09MOU08</b>	<b>11/16</b>	<b>3/4</b>	<b>19</b>	<b>22</b>	<b>25</b>	<b>40.5</b>	<b>420</b>	<b>6091</b>
LMO09MOU10	11/16	7/8	22	27	28	50	420	6091
<b>LMO09MOU12</b>	<b>11/16</b>	<b>1.1/16</b>	<b>27</b>	<b>32</b>	<b>29.5</b>	<b>55</b>	<b>420</b>	<b>6091</b>
LMO11MOU06	13/16	9/16	22	17	28	37	420	6091
<b>LMO11MOU10</b>	<b>13/16</b>	<b>7/8</b>	<b>22</b>	<b>27</b>	<b>30</b>	<b>50</b>	<b>420</b>	<b>6091</b>
LMO11MOU12	13/16	1.1/16	27	32	31.5	55	420	6091

## 90° NASTAWNA ZŁĄCZKA MĘSKA ORFS - MĘSKA UNF Z O - RINGIEM (2)

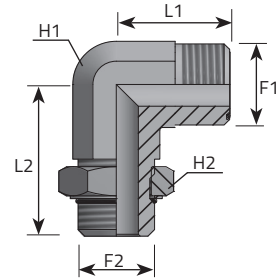

Code	Thread		Dimensions				Pressure	
	F1 in	F2 in	H1 mm	H2 mm	L1 mm	L2 mm	Bar	Psi
LMO13MOU08	1	3/4	27	22	33.5	46	420	6091
LMO13MOU12	1	1.1/16	27	32	33.5	55	420	6091
LMO14MOU08	1.3/16	3/4	30	22	37.5	47	420	6091
LMO14MOU10	1.3/16	7/8	30	27	37.5	51	420	6091
LMO14MOU16	1.3/16	1.5/16	33	41	38	59.5	380	5511
LMO15MOU12	1.7/16	1.1/16	36	32	41.5	59	420	6091
LMO15MOU20	1.7/16	1.5/8	41	50	44.5	62	280	4060
LMO21MOU16	1.11/16	1.5/16	41	41	52	62	280	4060
LMO21MOU24	1.11/16	1.7/8	48	55	52	66	280	4060
LMO32MOU20	2	1.5/8	48	50	49	66	280	4060

## 45° NASTAWNA ZŁĄCZKA MĘSKA ORFS - MĘSKA BSPP Z O - RINGIEM (1)

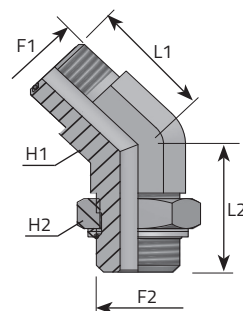

Code	Thread		Dimensions				Pressure	
	F1 in	F2 in	H1 mm	H2 mm	L1 mm	L2 mm	Bar	Psi
QMO06MOG02	9/16	1/8	14	14	16	27.5	350	5076
<b>QMO09MOG04</b>	<b>11/16</b>	<b>1/4</b>	<b>19</b>	<b>19</b>	<b>19</b>	<b>32.5</b>	<b>315</b>	<b>4568</b>
QMO11MOG06	13/16	3/8	22	22	20.5	33.5	250	3625
<b>QMO13MOG08</b>	<b>1</b>	<b>1/2</b>	<b>27</b>	<b>27</b>	<b>23.5</b>	<b>43</b>	<b>250</b>	<b>3625</b>
QMO14MOG12	1.3/16	3/4	30	36	26	46.5	250	3625
<b>QMO15MOG16</b>	<b>1.7/16</b>	<b>1</b>	<b>36</b>	<b>41</b>	<b>30</b>	<b>51</b>	<b>200</b>	<b>2900</b>
QMO21MOG20	1.11/16	1.1/4	41	50	32	52.5	200	2900
<b>QMO32MOG24</b>	<b>2</b>	<b>1.1/2</b>	<b>48</b>	<b>55</b>	<b>37</b>	<b>52.5</b>	<b>160</b>	<b>2320</b>
QMO06MOG04	9/16	1/4	14	19	16	31.5	315	4568
<b>QMO06MOG06</b>	<b>9/16</b>	<b>3/8</b>	<b>19</b>	<b>22</b>	<b>17.5</b>	<b>33.5</b>	<b>250</b>	<b>3625</b>
QMO09MOG06	11/16	3/8	19	22	19	33.5	250	3625
<b>QMO09MOG08</b>	<b>11/16</b>	<b>1/2</b>	<b>22</b>	<b>27</b>	<b>20</b>	<b>43</b>	<b>250</b>	<b>3625</b>
QMO11MOG04	13/16	1/4	22	19	20.5	32.5	315	4568
<b>QMO11MOG08</b>	<b>13/16</b>	<b>1/2</b>	<b>22</b>	<b>27</b>	<b>21</b>	<b>43</b>	<b>250</b>	<b>3625</b>
QMO11MOG12	13/16	3/4	27	36	21.5	46.5	250	3625
<b>QMO13MOG04</b>	<b>1</b>	<b>1/4</b>	<b>27</b>	<b>19</b>	<b>23.5</b>	<b>36</b>	<b>315</b>	<b>4568</b>
QMO13MOG06	1	3/8	27	22	23.5	37	250	3625
<b>QMO13MOG12</b>	<b>1</b>	<b>3/4</b>	<b>27</b>	<b>36</b>	<b>23.5</b>	<b>46.5</b>	<b>250</b>	<b>3625</b>

## 45° NASTAWNA ZŁĄCZKA MĘSKA ORFS - MĘSKA BSPP Z O - RINGIEM (2)

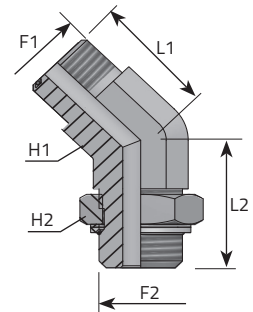

Code	Thread		Dimensions				Pressure	
	F1 in	F2 in	H1 mm	H2 mm	L1 mm	L2 mm	Bar	Psi
QMO13MOG16	1	1	33	41	28.5	51	200	2900
<b>QMO14MOG04</b>	<b>1.3/16</b>	<b>1/4</b>	<b>30</b>	<b>19</b>	<b>26</b>	<b>40.5</b>	<b>315</b>	<b>4568</b>
QMO14MOG08	1.3/16	1/2	30	27	26	44.5	250	3625
<b>QMO14MOG16</b>	<b>1.3/16</b>	<b>1</b>	<b>33</b>	<b>41</b>	<b>29.5</b>	<b>51</b>	<b>200</b>	<b>2900</b>
QMO15MOG04	1.7/16	1/4	36	19	30	41	315	4568
<b>QMO15MOG12</b>	<b>1.7/16</b>	<b>3/4</b>	<b>36</b>	<b>36</b>	<b>30</b>	<b>47</b>	<b>250</b>	<b>3625</b>
QMO15MOG20	1.7/16	1.1/4	41	50	32	52.5	200	2900
<b>QMO21MOG16</b>	<b>1.11/16</b>	<b>1</b>	<b>41</b>	<b>41</b>	<b>32</b>	<b>52.5</b>	<b>200</b>	<b>2900</b>
QMO21MOG24	1.11/16	1.1/2	48	55	35.5	52.5	160	2320

## 45° NASTAWNA ZŁĄCZKA MĘSKA ORFS - METRYCZNA MĘSKA Z O - RINGIEM

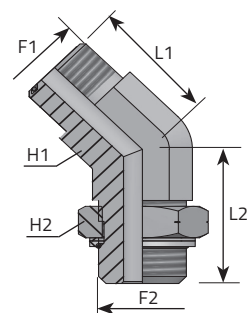

Code	Thread		Dimensions				Pressure	
	F1 in	F2 mm	H1 mm	H2 mm	L1 mm	L2 mm	Bar	Psi
QMO06MOM12R	9/16	12X1.5	14	17	16	30	315	4568
<b>QMO09MOM14R</b>	<b>11/16</b>	<b>14X1.5</b>	<b>19</b>	<b>19</b>	<b>19</b>	<b>31</b>	<b>315</b>	<b>4568</b>
QMO11MOM18R	13/16	18X1.5	22	24	20.5	36.5	315	4568
QMO13MOM22R	1	22X1.5	27	27	23.5	44	250	3625
QMO14MOM27R	1.3/16	27X2	30	32	26	50	250	3625
QMO15MOM33R	1.7/16	33X2	36	41	30	52.5	250	3625
QMO21MOM42R	1.11/16	42X2	41	50	32	54	160	2320
QMO32MOM48R	2	48X2	48	55	37	56.5	160	2320
QMO06MOM10R	9/16	10X1	14	14	16	27	315	4568
<b>QMO09MOM16R</b>	<b>11/16</b>	<b>16X1.5</b>	<b>19</b>	<b>22</b>	<b>19</b>	<b>33</b>	<b>315</b>	<b>4568</b>
QMO11MOM16R	13/16	16X1.5	22	22	20.5	33	315	4568
QMO11MOM22R	13/16	22X1.5	27	27	21.5	44	250	3625
QMO13MOM18R	1	18X1.5	27	24	23.5	42.5	315	4568
QMO13MOM27R	1	27X2	27	32	23.5	50	250	3625
QMO14MOM22R	1.3/16	22X1.5	30	27	26	44	250	3625
QMO14MOM33R	1.3/16	33X2	33	41	29.5	52.5	160	2320
QMO15MOM27R	1.7/16	27X2	36	32	30	52.5	250	3625
QMO15MOM42R	1.7/16	42X2	41	50	32	54	160	2320
QMO21MOM48R	1.11/16	48X2	48	55	35.5	56.5	160	2320

## 45° NASTAWNA ZŁĄCZKA MĘSKA ORFS - MĘSKA UNF Z O - RINGIEM (1)

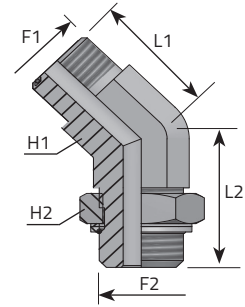

Code	Thread		Dimensions				Pressure	
	F1	F2	H1	H2	L1	L2	Bar	Psi
	in	in	mm	mm	mm	mm		
QMO06MOU04	9/16	7/16	14	14	16	30	420	6091
QMO09MOU06	11/16	9/16	19	17	19	33	420	6091
QMO11MOU08	13/16	3/4	22	22	20.5	36.5	420	6091
QMO13MOU10	1	7/8	27	27	23.5	45	420	6091
QMO14MOU12	1.3/16	1.1/16	30	32	26	50	420	6091
QMO15MOU16	1.7/16	1.5/16	36	41	30	52.5	380	5511
QMO21MOU20	1.11/16	1.5/8	41	50	32	53.5	280	4060
QMO32MOU24	2	1.7/8	48	55	37	53.5	280	4060
QMO06MOU06	9/16	9/16	14	17	16	33	420	6091
QMO06MOU08	9/16	3/4	19	22	17.5	36.5	420	6091
QMO09MOU04	11/16	7/16	19	14	19	31	420	6091
QMO09MOU08	11/16	3/4	19	22	19	36.5	420	6091
QMO09MOU10	11/16	7/8	22	27	20	45	420	6091
QMO09MOU12	11/16	1.1/16	27	32	19.5	50	420	6091
QMO11MOU06	13/16	9/16	22	17	20.5	32.5	420	6091
QMO11MOU10	13/16	7/8	22	27	21	45	420	6091
QMO11MOU12	13/16	1.1/16	27	32	21.5	50	420	6091



## 45° NASTAWNA ZŁĄCZKA MĘSKA ORFS - MĘSKA UNF Z O - RINGIEM (2)

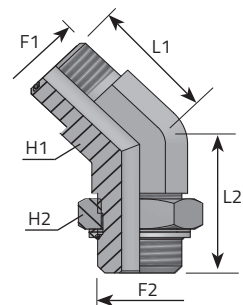

Code	Thread		Dimensions				Pressure	
	F1 in	F2 in	H1 mm	H2 mm	L1 mm	L2 mm	Bar	Psi
QMO13MOU08	1	3/4	27	22	23.5	40.5	420	6091
QMO13MOU12	1	1.1/16	27	32	23.5	50	420	6091
QMO14MOU08	1.3/16	3/4	30	22	26	40.5	420	6091
QMO14MOU10	1.3/16	7/8	30	27	26	46	420	6091
QMO14MOU16	1.3/16	1.5/16	33	41	29.5	52.5	380	5511
QMO15MOU12	1.7/16	1.1/16	36	32	30	51.5	420	6091
QMO15MOU20	1.7/16	1.5/8	41	50	32	53.5	280	4060
QMO21MOU16	1.11/16	1.5/16	41	41	32	53.5	280	4060
QMO21MOU24	1.11/16	1.7/8	48	55	35.5	53.5	280	4060
QMO32MOU20	2	1.5/8	48	50	37	53.5	280	4060

## TRÓJNIK MĘSKI ORFS - NASTAWNA MĘSKA BSPP Z O - RINGIEM (1)

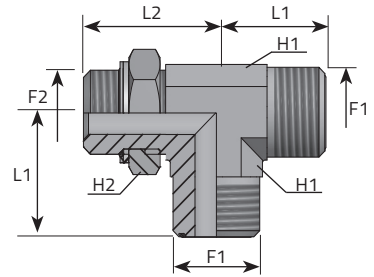

Code	Thread		Dimensions				Pressure	
	F1 in	F2 in	H1 mm	H2 mm	L1 mm	L2 mm	Bar	Psi
TMO06MOG02B	9/16	1/8	14	14	21.5	30	350	5076
<b>TMO09MOG04B</b>	<b>11/16</b>	<b>1/4</b>	<b>19</b>	<b>19</b>	<b>25</b>	<b>37</b>	<b>315</b>	<b>4568</b>
TMO11MOG06B	13/16	3/8	22	22	28	38	250	3625
<b>TMO13MOG08B</b>	<b>1</b>	<b>1/2</b>	<b>27</b>	<b>27</b>	<b>33.5</b>	<b>48</b>	<b>250</b>	<b>3625</b>
TMO14MOG12B	1.3/16	3/4	30	36	37.5	51.5	250	3625
<b>TMO15MOG16B</b>	<b>1.7/16</b>	<b>1</b>	<b>36</b>	<b>41</b>	<b>41.5</b>	<b>58.5</b>	<b>200</b>	<b>2900</b>
TMO21MOG20B	1.11/16	1.1/4	41	50	44.5	60.5	200	2900
<b>TMO32MOG24B</b>	<b>2</b>	<b>1.1/2</b>	<b>48</b>	<b>55</b>	<b>49</b>	<b>64</b>	<b>160</b>	<b>2320</b>
TMO06MOG04B	9/16	1/4	14	19	21.5	35	315	4568
<b>TMO06MOG06B</b>	<b>9/16</b>	<b>3/8</b>	<b>19</b>	<b>22</b>	<b>23.5</b>	<b>38</b>	<b>250</b>	<b>3625</b>
TMO09MOG06B	11/16	3/8	19	22	25	38	250	3625
<b>TMO09MOG08B</b>	<b>11/16</b>	<b>1/2</b>	<b>22</b>	<b>27</b>	<b>28</b>	<b>48</b>	<b>250</b>	<b>3625</b>
TMO11MOG04B	13/16	1/4	22	19	28	37	315	4568
<b>TMO11MOG08B</b>	<b>13/16</b>	<b>1/2</b>	<b>22</b>	<b>27</b>	<b>30</b>	<b>48</b>	<b>250</b>	<b>3625</b>
TMO11MOG12B	13/16	3/4	27	36	31.5	51.5	250	3625
<b>TMO13MOG04B</b>	<b>1</b>	<b>1/4</b>	<b>27</b>	<b>19</b>	<b>33.5</b>	<b>42.5</b>	<b>315</b>	<b>4568</b>
TMO13MOG06B	1	3/8	27	22	33.5	42.5	250	3625
<b>TMO13MOG12B</b>	<b>1</b>	<b>3/4</b>	<b>27</b>	<b>36</b>	<b>33.5</b>	<b>51.5</b>	<b>250</b>	<b>3625</b>

## TRÓJNIK MĘSKI ORFS - NASTAWNA MĘSKA BSPP Z O - RINGIEM (2)

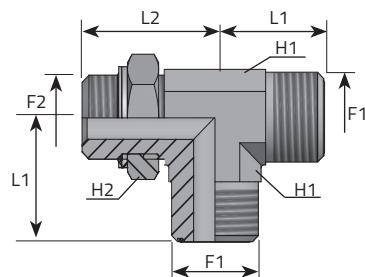

Code	Thread		Dimensions				Pressure	
	F1	F2	H1	H2	L1	L2	Bar	Psi
	in	in	mm	mm	mm	mm		
TMO13MOG16B	1	1	33	41	37	58.5	200	2900
<b>TMO14MOG04B</b>	<b>1.3/16</b>	<b>1/4</b>	<b>30</b>	<b>19</b>	<b>37.5</b>	<b>43.5</b>	<b>315</b>	<b>4568</b>
TMO14MOG08B	1.3/16	1/2	30	27	37.5	49	250	3625
<b>TMO14MOG16B</b>	<b>1.3/16</b>	<b>1</b>	<b>33</b>	<b>41</b>	<b>42</b>	<b>54</b>	<b>200</b>	<b>2900</b>
TMO15MOG04B	1.7/16	1/4	36	19	41.5	52	315	4568
<b>TMO15MOG12B</b>	<b>1.7/16</b>	<b>3/4</b>	<b>36</b>	<b>36</b>	<b>41.5</b>	<b>57.5</b>	<b>250</b>	<b>3625</b>
TMO15MOG20B	1.7/16	1.1/4	41	50	44.5	60.5	200	2900
<b>TMO21MOG16B</b>	<b>1.11/16</b>	<b>1</b>	<b>41</b>	<b>41</b>	<b>44.5</b>	<b>60.5</b>	<b>200</b>	<b>2900</b>
TMO21MOG24B	1.11/16	1.1/2	48	55	48.5	64	160	2320

## TRÓJNIK MĘSKI ORFS - NASTAWNA METRYCZNA MĘSKA Z O - RINGIEM

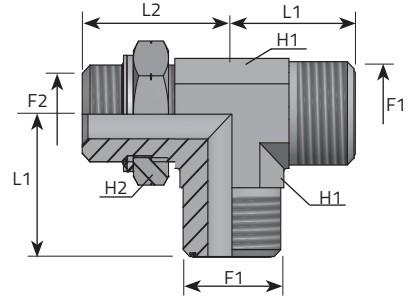

Code	Thread		Dimensions				Pressure	
	F1 in	F2 mm	H1 mm	H2 mm	L1 mm	L2 mm	Bar	Psi
TMO06MOM12RB	9/16	12X1.5	14	17	21.5	33	315	4568
<b>TMO09MOM14RB</b>	<b>11/16</b>	<b>14X1.5</b>	<b>19</b>	<b>19</b>	<b>25</b>	<b>35.5</b>	<b>315</b>	<b>4568</b>
TMO11MOM18RB	13/16	18X1.5	22	24	28	41	315	4568
<b>TMO13MOM22RB</b>	<b>1</b>	<b>22X1.5</b>	<b>27</b>	<b>27</b>	<b>33.5</b>	<b>49</b>	<b>250</b>	<b>3625</b>
TMO14MOM27RB	1.3/16	27X2	30	32	37.5	55.5	250	3625
<b>TMO15MOM33RB</b>	<b>1.7/16</b>	<b>33X2</b>	<b>36</b>	<b>41</b>	<b>41.5</b>	<b>59.5</b>	<b>160</b>	<b>2320</b>
TMO21MOM42RB	1.11/16	42X2	41	50	44.5	63	160	2320
<b>TMO32MOM48RB</b>	<b>2</b>	<b>48X2</b>	<b>48</b>	<b>55</b>	<b>49</b>	<b>68.5</b>	<b>160</b>	<b>2320</b>
TMO06MOM10RB	9/16	10X1	14	14	21.5	30	315	4568
<b>TMO09MOM16RB</b>	<b>11/16</b>	<b>16X1.5</b>	<b>19</b>	<b>22</b>	<b>25</b>	<b>37.5</b>	<b>315</b>	<b>4568</b>
TMO11MOM16RB	13/16	16X1.5	22	22	28	37.5	315	4568
<b>TMO11MOM22RB</b>	<b>13/16</b>	<b>22X1.5</b>	<b>27</b>	<b>27</b>	<b>31.5</b>	<b>49</b>	<b>250</b>	<b>3625</b>
TMO13MOM18RB	1	18X1.5	27	24	33.5	47.5	315	4568
<b>TMO13MOM27RB</b>	<b>1</b>	<b>27X2</b>	<b>27</b>	<b>32</b>	<b>33.5</b>	<b>55.5</b>	<b>250</b>	<b>3625</b>
TMO14MOM22RB	1.3/16	22X1.5	30	27	37.5	49.5	250	3625
<b>TMO14MOM33RB</b>	<b>1.3/16</b>	<b>33X2</b>	<b>33</b>	<b>41</b>	<b>38</b>	<b>59.5</b>	<b>160</b>	<b>2320</b>
TMO15MOM27RB	1.7/16	27X2	36	32	41.5	59.5	250	3625
<b>TMO15MOM42RB</b>	<b>1.7/16</b>	<b>42X2</b>	<b>41</b>	<b>50</b>	<b>44.5</b>	<b>63</b>	<b>160</b>	<b>2320</b>
TMO21MOM48RB	1.11/16	48X2	48	55	48.5	68.5	160	2320

## TRÓJNIK MĘSKI ORFS - MĘSKA UNF Z O - RINGIEM

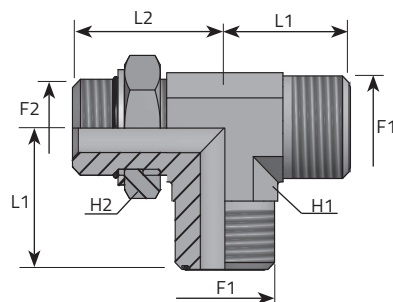

Code	Thread		Dimensions				Pressure	
	F1	F2	H1	H2	L1	L2	Bar	Psi
	in	in	mm	mm	mm	mm		
TMO06MOU04B	9/16	7/16	14	14	21.5	32.5	420	6091
<b>TMO09MOU06B</b>	<b>11/16</b>	<b>9/16</b>	<b>19</b>	<b>17</b>	<b>25</b>	<b>37</b>	<b>420</b>	<b>6091</b>
TMO11MOU08B	13/16	3/4	22	22	28	40.5	420	6091
<b>TMO13MOU10B</b>	<b>1</b>	<b>7/8</b>	<b>27</b>	<b>27</b>	<b>33.5</b>	<b>50</b>	<b>420</b>	<b>6091</b>
TMO14MOU12B	1.3/16	1.1/16	30	32	37.5	55	420	6091
<b>TMO15MOU16B</b>	<b>1.7/16</b>	<b>1.5/16</b>	<b>36</b>	<b>41</b>	<b>41.5</b>	<b>59.5</b>	<b>380</b>	<b>5511</b>
TMO21MOU20B	1.11/16	1.5/8	41	50	44.5	62	280	4060
<b>TMO32MOU24B</b>	<b>2</b>	<b>1.7/8</b>	<b>48</b>	<b>55</b>	<b>49</b>	<b>66</b>	<b>280</b>	<b>4060</b>
TMO06MOU06B	9/16	9/16	14	17	21.5	34.5	420	6091
<b>TMO06MOG08B</b>	<b>9/16</b>	<b>3/4</b>	<b>19</b>	<b>22</b>	<b>23.5</b>	<b>40.5</b>	<b>420</b>	<b>6091</b>
TMO09MOU04B	11/16	7/16	19	14	25	35	420	6091
<b>TMO09MOU08B</b>	<b>11/16</b>	<b>3/4</b>	<b>19</b>	<b>22</b>	<b>25</b>	<b>40.5</b>	<b>420</b>	<b>6091</b>
TMO09MOU10B	11/16	7/8	22	27	28	50	420	6091
<b>TMO09MOU12B</b>	<b>11/16</b>	<b>1.1/16</b>	<b>27</b>	<b>32</b>	<b>29.5</b>	<b>55</b>	<b>420</b>	<b>6091</b>
TMO11MOU06B	13/16	9/16	22	17	28	37	420	6091
<b>TMO11MOU10B</b>	<b>13/16</b>	<b>7/8</b>	<b>22</b>	<b>27</b>	<b>30</b>	<b>50</b>	<b>420</b>	<b>6091</b>
TMO11MOU12B	13/16	1.1/16	27	32	31.5	55	420	6091

## TRÓJNIK MĘSKI ORFS - MĘSKA UNF Z O - RINGIEM (2)

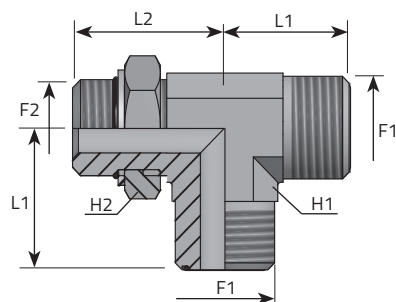

Code	Thread		Dimensions				Pressure	
	F1 in	F2 in	H1 mm	H2 mm	L1 mm	L2 mm	Bar	Psi
TMO13MOU08B	1	3/4	27	22	33.5	46	420	6091
<b>TMO13MOU12B</b>	<b>1</b>	<b>1.1/16</b>	<b>27</b>	<b>32</b>	<b>33.5</b>	<b>55</b>	<b>420</b>	<b>6091</b>
TMO14MOU08B	1.3/16	3/4	30	22	37.5	47	420	6091
<b>TMO14MOU10B</b>	<b>1.3/16</b>	<b>7/8</b>	<b>30</b>	<b>27</b>	<b>37.5</b>	<b>51</b>	<b>420</b>	<b>6091</b>
TMO14MOU16B	1.3/16	1.5/16	33	41	38	59.5	380	5511
<b>TMO15MOU12B</b>	<b>1.7/16</b>	<b>1.1/16</b>	<b>36</b>	<b>32</b>	<b>41.5</b>	<b>59</b>	<b>420</b>	<b>6091</b>
TMO15MOU20B	1.7/16	1.5/8	41	50	44.5	62	280	4060
<b>TMO21MOU16B</b>	<b>1.11/16</b>	<b>1.5/16</b>	<b>41</b>	<b>41</b>	<b>44.5</b>	<b>62</b>	<b>280</b>	<b>4060</b>
TMO21MOU24B	1.11/16	1.7/8	48	55	48.5	66	280	4060
<b>TMO32MOU20B</b>	<b>2</b>	<b>1.5/8</b>	<b>48</b>	<b>50</b>	<b>49</b>	<b>66</b>	<b>280</b>	<b>4060</b>

## TRÓJNIK MĘSKI ORFS - NASTAWNA MĘSKA BSPP Z O - RINGIEM (1)

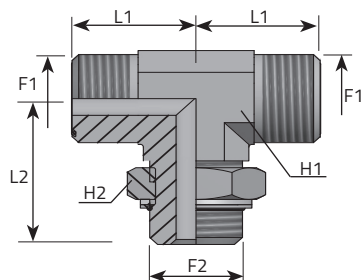

Code	Thread		Dimensions				Pressure	
	F1 in	F2 in	H1 mm	H2 mm	L1 mm	L2 mm	Bar	Psi
TMO06MOG02P	9/16	1/8	14	14	21.5	30	350	5076
<b>TMO09MOG04P</b>	<b>11/16</b>	<b>1/4</b>	<b>19</b>	<b>19</b>	<b>25</b>	<b>37</b>	<b>315</b>	<b>4568</b>
TMO11MOG06P	13/16	3/8	22	22	28	38	250	3625
<b>TMO13MOG08P</b>	<b>1</b>	<b>1/2</b>	<b>27</b>	<b>27</b>	<b>33.5</b>	<b>48</b>	<b>250</b>	<b>3625</b>
TMO14MOG12P	1.3/16	3/4	30	36	37.5	51.5	250	3625
<b>TMO15MOG16P</b>	<b>1.7/16</b>	<b>1</b>	<b>36</b>	<b>41</b>	<b>41.5</b>	<b>58.5</b>	<b>200</b>	<b>2900</b>
TMO21MOG20P	1.11/16	1.1/4	41	50	44.5	60.5	200	2900
<b>TMO32MOG24P</b>	<b>2</b>	<b>1.1/2</b>	<b>48</b>	<b>55</b>	<b>49</b>	<b>64</b>	<b>160</b>	<b>2320</b>
TMO06MOG04P	9/16	1/4	14	19	21.5	35	315	4568
<b>TMO06MOG06P</b>	<b>9/16</b>	<b>3/8</b>	<b>19</b>	<b>22</b>	<b>23.5</b>	<b>38</b>	<b>250</b>	<b>3625</b>
TMO09MOG06P	11/16	3/8	19	22	25	38	250	3625
<b>TMO09MOG08P</b>	<b>11/16</b>	<b>1/2</b>	<b>22</b>	<b>27</b>	<b>28</b>	<b>48</b>	<b>250</b>	<b>3625</b>
TMO11MOG04P	13/16	1/4	22	19	28	37	315	4568
<b>TMO11MOG08P</b>	<b>13/16</b>	<b>1/2</b>	<b>22</b>	<b>27</b>	<b>30</b>	<b>48</b>	<b>250</b>	<b>3625</b>
TMO11MOG12P	13/16	3/4	27	36	31.5	51.5	250	3625
<b>TMO13MOG04P</b>	<b>1</b>	<b>1/4</b>	<b>27</b>	<b>19</b>	<b>33.5</b>	<b>42.5</b>	<b>315</b>	<b>4568</b>
TMO13MOG06P	1	3/8	27	22	33.5	42.5	250	3625
<b>TMO13MOG12P</b>	<b>1</b>	<b>3/4</b>	<b>27</b>	<b>36</b>	<b>33.5</b>	<b>51.5</b>	<b>250</b>	<b>3625</b>

## TRÓJNIK MĘSKI ORFS - NASTAWNA MĘSKA BSPP Z O - RINGIEM (2)

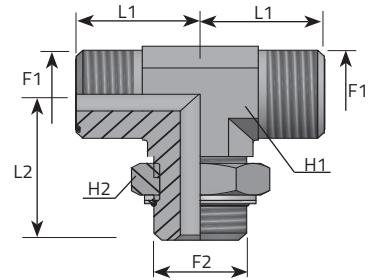

Code	Thread		Dimensions				Pressure	
	F1 in	F2 in	H1 mm	H2 mm	L1 mm	L2 mm	Bar	Psi
TMO13MOG16P	1	1	33	41	37	58.5	200	2900
<b>TMO14MOG04P</b>	<b>1.3/16</b>	<b>1/4</b>	<b>30</b>	<b>19</b>	<b>37.5</b>	<b>43.5</b>	<b>315</b>	<b>4568</b>
TMO14MOG08P	1.3/16	1/2	30	27	37.5	49	250	3625
<b>TMO14MOG16P</b>	<b>1.3/16</b>	<b>1</b>	<b>33</b>	<b>41</b>	<b>42</b>	<b>54</b>	<b>200</b>	<b>2900</b>
TMO15MOG04P	1.7/16	1/4	36	19	41.5	52	315	4568
<b>TMO15MOG12P</b>	<b>1.7/16</b>	<b>3/4</b>	<b>36</b>	<b>36</b>	<b>41.5</b>	<b>57.5</b>	<b>250</b>	<b>3625</b>
TMO15MOG20P	1.7/16	1.1/4	41	50	44.5	60.5	200	2900
<b>TMO21MOG16P</b>	<b>1.11/16</b>	<b>1</b>	<b>41</b>	<b>41</b>	<b>44.5</b>	<b>60.5</b>	<b>200</b>	<b>2900</b>
TMO21MOG24P	1.11/16	1.1/2	48	55	48.5	64	160	2320



## TRÓJNIK MĘSKI ORFS - NASTAWNA METRYCZNA MĘSKA Z O - RINGIEM

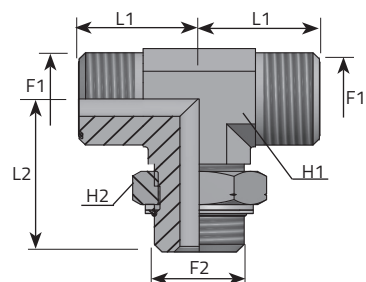

Code	Thread		Dimensions				Pressure	
	F1 in	F2 mm	H1 mm	H2 mm	L1 mm	L2 mm	Bar	Psi
TMO06MOM12RP	9/16	12X1.5	14	17	21.5	33	315	4568
<b>TMO09MOM14RP</b>	<b>11/16</b>	<b>14X1.5</b>	<b>19</b>	<b>19</b>	<b>25</b>	<b>35.5</b>	<b>315</b>	<b>4568</b>
TMO11MOM18RP	13/16	18X1.5	22	24	28	41	315	4568
TMO13MOM22RP	1	22X1.5	27	27	33.5	49	250	3625
TMO14MOM27RP	1.3/16	27X2	30	32	37.5	55.5	250	3625
TMO15MOM33RP	1.7/16	33X2	36	41	41.5	59.5	160	2320
TMO21MOM42RP	1.11/16	42X2	41	50	44.5	63	160	2320
TMO32MOM48RP	2	48X2	48	55	49	68.5	160	2320
TMO06MOM10RP	9/16	10X1	14	14	21.5	30	315	4568
<b>TMO09MOM16RP</b>	<b>11/16</b>	<b>16X1.5</b>	<b>19</b>	<b>22</b>	<b>25</b>	<b>37.5</b>	<b>315</b>	<b>4568</b>
TMO11MOM16RP	13/16	16X1.5	22	22	28	37.5	315	4568
TMO11MOM22RP	13/16	22X1.5	27	27	31.5	49	250	3625
TMO13MOM18RP	1	18X1.5	27	24	33.5	47.5	315	4568
TMO13MOM27RP	1	27X2	27	32	33.5	55.5	250	3625
TMO14MOM22RP	1.3/16	22X1.5	30	27	37.5	49.5	250	3625
TMO14MOM33RP	1.3/16	33X2	33	41	38	59.5	160	2320
TMO15MOM27RP	1.7/16	27X2	36	32	41.5	59.5	250	3625
TMO15MOM42RP	1.7/16	42X2	41	50	44.5	63	160	2320
TMO21MOM48RP	1.11/16	48X2	48	55	48.5	68.5	160	2320

## NASTAWNA TRÓJNIK MĘSKI ORFS - MĘSKA UNF Z O - RINGIEM (1)

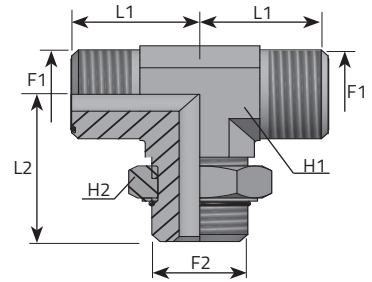

Code	Thread		Dimensions				Pressure	
	F1 in	F2 in	H1 mm	H2 mm	L1 mm	L2 mm	Bar	Psi
TMO06MOU04P	9/16	7/16	14	14	21.5	32.5	420	6091
<b>TMO09MOU06P</b>	<b>11/16</b>	<b>9/16</b>	<b>19</b>	<b>17</b>	<b>25</b>	<b>37</b>	<b>420</b>	<b>6091</b>
TMO11MOU08P	13/16	3/4	22	22	28	40.5	420	6091
<b>TMO13MOU10P</b>	<b>1</b>	<b>7/8</b>	<b>27</b>	<b>27</b>	<b>33.5</b>	<b>50</b>	<b>420</b>	<b>6091</b>
TMO14MOU12P	1.3/16	1.1/16	30	32	37.5	55	420	6091
<b>TMO15MOU16P</b>	<b>1.7/16</b>	<b>1.5/16</b>	<b>36</b>	<b>41</b>	<b>41.5</b>	<b>59.5</b>	<b>380</b>	<b>5511</b>
TMO21MOU20P	1.11/16	1.5/8	41	50	44.5	62	280	4060
<b>TMO32MOU24P</b>	<b>2</b>	<b>1.7/8</b>	<b>48</b>	<b>55</b>	<b>49</b>	<b>66</b>	<b>280</b>	<b>4060</b>
TMO06MOU06P	9/16	9/16	14	17	21.5	34.5	420	6091
<b>TMO06MOU08P</b>	<b>9/16</b>	<b>3/4</b>	<b>19</b>	<b>22</b>	<b>23.5</b>	<b>40.5</b>	<b>420</b>	<b>6091</b>
TMO09MOU04P	11/16	7/16	19	14	25	35	420	6091
<b>TMO09MOU08P</b>	<b>11/16</b>	<b>3/4</b>	<b>19</b>	<b>22</b>	<b>25</b>	<b>40.5</b>	<b>420</b>	<b>6091</b>
TMO09MOU10P	11/16	7/8	22	27	28	50	420	6091
<b>TMO09MOU12P</b>	<b>11/16</b>	<b>1.1/16</b>	<b>27</b>	<b>32</b>	<b>29.5</b>	<b>55</b>	<b>420</b>	<b>6091</b>
TMO11MOU06P	13/16	9/16	22	17	28	37	420	6091
<b>TMO11MOU10P</b>	<b>13/16</b>	<b>7/8</b>	<b>22</b>	<b>27</b>	<b>30</b>	<b>50</b>	<b>420</b>	<b>6091</b>
TMO11MOU12P	13/16	1.1/16	27	32	31.5	55	420	6091

## NASTAWNA TRÓJNIK MĘSKI ORFS - MĘSKA UNF Z O - RINGIEM (2)

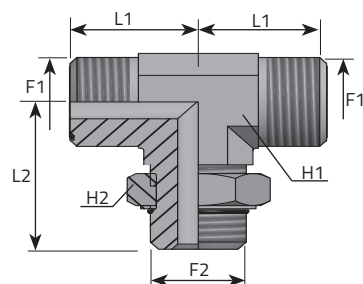

Code	Thread		Dimensions				Pressure	
	F1 in	F2 in	H1 mm	H2 mm	L1 mm	L1 mm	Bar	Psi
TMO13MOU08P	1	3/4	27	22	33.5	46	420	6091
TMO13MOU12P	1	1.1/16	27	32	33.5	55	420	6091
TMO14MOU08P	1.3/16	3/4	30	22	37.5	47	420	6091
TMO14MOU10P	1.3/16	7/8	30	27	37.5	51	420	6091
TMO14MOU16P	1.3/16	1.5/16	33	41	38	59.5	380	5511
TMO15MOU12P	1.7/16	1.1/16	36	32	41.5	59	420	6091
TMO15MOU20P	1.7/16	1.5/8	41	50	44.5	62	280	4060
TMO21MOU16P	1.11/16	1.5/16	41	41	44.5	62	280	4060
TMO21MOU24P	1.11/16	1.7/8	48	55	48.5	66	280	4060
TMO32MOU20P	2	1.5/8	48	50	49	66	280	4060

## 90° ZŁĄCZKA ZEŃSKA ORFS - NASTAWNA MĘSKA BSPP Z O - RINGIEM

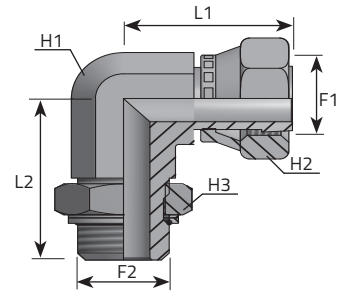

Code	Thread		Dimensions					Pressure	
	F1 in	F2 in	H1 mm	H2 mm	H3 mm	L1 mm	L2 mm	Bar	Psi
LFGO06MOG02	9/16	1/8	14	17	14	26.5	30	350	5076
<b>LFGO09MOG04</b>	<b>11/16</b>	<b>1/4</b>	<b>19</b>	<b>22</b>	<b>19</b>	<b>29</b>	<b>37</b>	<b>315</b>	<b>4568</b>
LFGO11MOG06	13/16	3/8	22	24	22	38	38	250	3625
<b>LFGO13MOG08</b>	<b>1</b>	<b>1/2</b>	<b>27</b>	<b>30</b>	<b>27</b>	<b>41</b>	<b>48</b>	<b>250</b>	<b>3625</b>
LFGO14MOG12	1.3/16	3/4	30	36	36	46.5	51.5	250	3625
<b>LFGO15MOG16</b>	<b>1.7/16</b>	<b>1</b>	<b>36</b>	<b>41</b>	<b>41</b>	<b>53.5</b>	<b>58.5</b>	<b>200</b>	<b>2900</b>
LFGO21MOG20	1.11/16	1.1/4	41	50	50	58	60.5	200	2900
<b>LFGO32MOG24</b>	<b>2</b>	<b>1.1/2</b>	<b>48</b>	<b>60</b>	<b>55</b>	<b>61</b>	<b>64</b>	<b>160</b>	<b>2320</b>

## 90° ZŁĄCZKA ZEŃSKA ORFS - NASTAWNA METRYCZNA MĘSKA Z O - RINGIEM

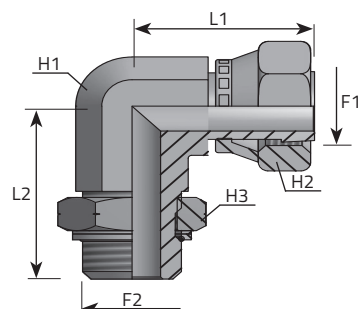

Code	Thread		Dimensions					Pressure	
	F1 in	F2 mm	H1 mm	H2 mm	H3 mm	L1 mm	L2 mm	Bar	Psi
LFG006MOM12R	9/16	12X1.5	14	17	17	26.5	33	315	4568
LFG009MOM14R	11/16	14X1.5	19	22	19	29	35.5	315	4568
LFG011MOM18R	13/16	18X1.5	22	24	24	38	41	315	4568
LFG013MOM22R	1	22X1.5	27	30	27	41	49	250	3625
LFG014MOM27R	1.3/16	27X2	30	36	32	46.5	55.5	250	3625
LFG015MOM33R	1.7/16	33X2	36	41	41	53.5	59.5	160	2320
LFG021MOM42R	1.11/16	42X2	41	50	50	58	63	160	2320
LFG032MOM48R	2	48X2	48	60	55	61	68.5	160	2320

## 90° ZŁĄCZKA ZEŃSKA ORFS- MĘSKA UNF Z O - RINGIEM

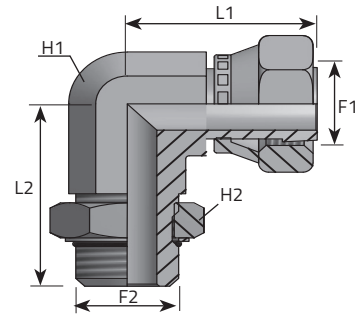

Code	Thread		Dimensions					Pressure	
	F1 in	F2 in	H1 mm	H2 mm	H3 mm	L1 mm	L2 mm	Bar	Psi
LFG006MOU04	9/16	7/16	14	17	14	26.5	32.5	420	6091
LFG009MOU06	11/16	9/16	19	22	17	29	37	420	6091
LFG011MOU08	13/16	3/4	22	24	22	38	40.5	420	6091
LFG013MOU10	1	7/8	27	30	27	41	50	420	6091
LFG014MOU12	1.3/16	1.1/16	30	36	32	46.5	55	420	6091
LFG015MOU16	1.7/16	1.5/16	36	41	41	53.5	59.5	380	5511
LFG021MOU20	1.11/16	1.5/8	41	50	50	58	62	280	4060
LFG032MOU24	2	1.7/8	48	60	55	61	66	280	4060

## MĘSKI KOREK UNF/UN - 2A

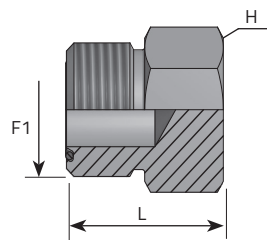

Code	Thread	Dimensions		Pressure	
		H1	L1	Bar	Psi
	F1 in	mm	mm		
ATM006	9/16	17	16.5	630	9136
ATM009	11/16	19	19	630	9136
ATM011	13/16	22	22	630	9136
ATM013	1	27	26	420	6091
ATM014	1.3/16	32	27.5	420	6091
ATM015	1.7/16	41	28	420	6091
ATM021	1.11/16	46	28	280	4060
ATM032	2	55	28	280	4060

## NAKRĘTKA OBROTOWA ŻEŃSKA KOREKUNF/UN - 2B

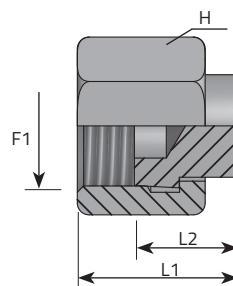

Code	Thread	Dimensions			Pressure	
		H	L1	L2	Bar	Psi
	F1 in	mm	mm	mm		
ATFG006	9/16	17	16.5	8.5	630	9136
ATFG009	11/16	22	18	9.5	630	9136
ATFG011	13/16	24	22	12	630	9136
ATFG013	1	30	24.5	12	420	6091
ATFG014	1.3/16	36	27	13.5	420	6091
ATFG015	1.7/16	41	28.5	15	420	6091
ATFG021	1.11/16	50	28.5	15	280	4060
ATFG032	2	60	28.5	15	280	4060









---

---

---

---

---

---

---

---

---

---

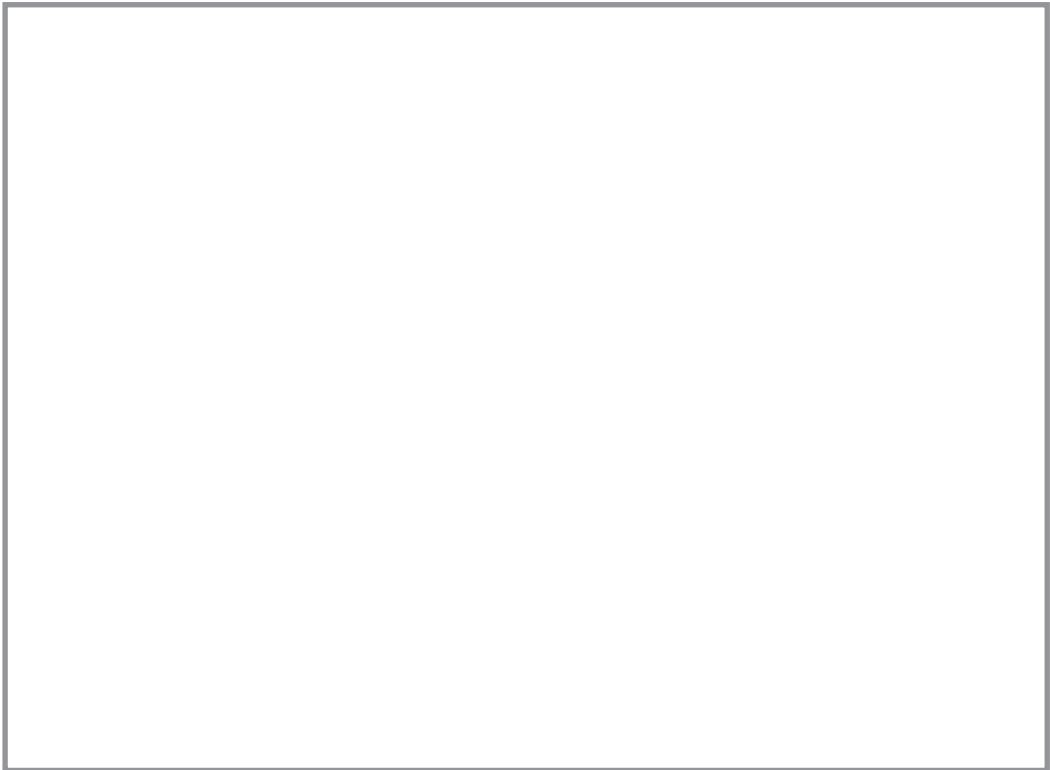





## **ORFS J1453** 0-2020 eu

Data reported in this catalogue are not binding.  
Vitulo S.p.a. reserves the right to change specifications without notice.

I dati riportati nella seguente pubblicazione non sono vincolanti.  
Vitulo S.p.a. si riserva di apportare modifiche senza preavviso.

Les données exposées dans ce catalogue ne sont pas contraignantes.  
Vitulo s.p.a se réserve le droit d'apporter des modifications sans aucun préavis.

Die vorliegenden Angaben sind nicht bindend.  
Vitulo S.p.a. behält sich technische Änderungen vor ohne Mitteilung.

Los datos referidos en la presente publicación son indicativos.  
Vitulo S.p.a. se reserva el derecho de modificar las especificaciones sin aviso previo.